



# SERVICE SUPPLY

**EARTHMOVERS, EXCAVATORS, TRUCK and TRAILER**

**OVER 5,000 HIGH QUALITY PRODUCTS DIRECT!**

**855-219-6387**

## YOUR JOB'S TOUGH ENOUGH- WE'RE HERE TO MAKE IT EASIER.

Our high-quality products were specifically chosen for those who operate, maintain, or haul heavy equipment. Our product line includes items from the following categories:

- Equipment Accessories
- Oil, Grease and Fuel Handling
- Truck and Trailer Accessories
- Lifting and Rigging
- Maintenance, Parts, Components, and Tooling
- Job Site Tools and Equipment
- Shop Equipment and Tooling
- Operations and Personnel

We're a small company, centrally located in Iowa. We pride ourselves on same-day shipping on all of our in-stock items and the same goes for the majority of our drop ship products as well. We offer only the best products from the best manufacturers to ensure your satisfaction. Give us a try, we won't disappoint!



## EQUIPMENT ACCESSORIES

### SERIES 2500 5" X 5" HALOGEN WORK LIGHTS

The ABL 2500 series work light is a robust, off-road work light designed for demanding applications. 6"H x 5-1/2"W x 4"D. H-3 HD Bulb. Flood beam. Clear color. 4 amp current. Choose from 12V or 24V, pedestal or suspended orientation.

12V Part #	Orientation	Connection	Cross Reference	Price
3A0033	Pedestal	Bare leads	CAT: 9X-7779, 9X-8179; Hyundai: 21M8-01300; John Deere: AT135485, AH145563; Komatsu: 1259012H92	<b>\$34<sup>66</sup></b>
3A0034	Suspended	Bare leads	CAT: 9X-9484, 151-2457, 9X-6853	<b>\$34<sup>70</sup></b>
24V Part #	Orientation	Connection	Cross Reference	Price
3A0037	Pedestal	Bare leads	CAT: 171-7214, 172-9973, 238-8638, 238-8639, 6V-1108, 6V-1119, 9X-1439, 9X-1443, 9X-1444, 9X-6775, 9X-7165, 9X-7169, 9X-9600; Hyundai: 21N6-20211; John Deere: AT168968; Komatsu: 1259011H92, 1436115H91	<b>\$32<sup>06</sup></b>
3A0038	Suspended	Bare leads	Case: 76036468, 76040180 CAT: 9X-4381, 9X-6774, 9X-6874, 133-3037, 2T-3739, 176-0780; John Deere: AT209902	<b>\$32<sup>06</sup></b>



### SHD BLUE LED SPOT FORKLIFT SAFETY LIGHT

The ABL 500 LED series work lights are designed to exceed everyday demands in all applications. This specific Blue version of our LED worklight range ensures a visible sharp edged warning signal on the floor for an increased safety environment.

- Lifetime: 20,000 hours
- Light pattern: sharp-edged spot
- Consumption: 5W
- Voltage: Multi 12-100V; Intensity: 0.2 Amp @ 24V
- Vibration resistance: 10 Grms, from 24Hz to 2000Hz
- 4.29" tall x 4.29" wide x 4.84" deep



Part #	Light Pattern	Bulb	Price
SP3A0008	Sharp Edged Spot	LED blue	<b>\$149<sup>95</sup></b>

### SL 1000 LED COMPACT WORK LIGHTS

Through this Service light version, ABL provides an attractive LED product for close range lighting needs. ABL 850 LED SL offers a low consumption (14 watts) solution where high reliability and cost efficiency are required.

- Pedestal mounting
- Connection: DT 2 pin
- 6000 K Color temperature
- Extremely long life (30,000 hours)
- Protected against reverse voltage
- Voltage: 12/24V; 14W consumption
- High vibration resistance
- Dimensions: 3.8"H x 4"W x 2.5"D.



Part #	Light Pattern	Bulb	Qty	Price
3A0067	Flood	1000 Lumen	1	<b>\$99<sup>95</sup></b>
3A0068	Long Range	1000 Lumen	1	<b>\$99<sup>95</sup></b>

### RL 1500 LED WORK LIGHT

The ABL RL 1500 LED series work lights are designed to exceed everyday demands in all applications. Through stringent engineering and testing practices, we ensure the highest efficiency and durability in even the harshest operating conditions.

- Pedestal mounting
- Connection: DT 2 pin
- 6000 K Color temperature
- Extremely long life (30,000 hours)
- Voltage: 12-24V; 20W consumption
- High vibration resistance
- 3.58" round x 3.03" deep



Part #	Light Pattern	Bulb	Qty	Price
3A0069	Flood	1500 Lumen	1	<b>\$139<sup>95</sup></b>
3A0070	Long Range	1500 Lumen	1	<b>\$139<sup>95</sup></b>

### SL 1500 LED COMPACT WORK LIGHTS

The ABL 1500 LED is a new LED work lamp with halogen performance, meeting the highest quality demands of the vehicle, forest and mining industry.

- Pedestal mounting
- DT 2 pin connector
- Brightness in day light color (6000 K)
- Low power consumption, 20W
- 12/24V
- Maintenance free
- Extremely long life (30,000 hrs)
- High vibration resistance
- Dimensions: 3.8"H x 4"W x 2.5"



Part #	Light Pattern	Lumens Output	Price
3A0063	Flood	1500 Lumen	<b>\$139<sup>95</sup></b>
3A0064	Spot	1500 Lumen	<b>\$139<sup>95</sup></b>

**MANY OPTIONS AVAILABLE FOR HIGH-QUALITY LIGHTS ON OUR WEBSITE!**

**ENCLOSED IS A SMALL SAMPLING OF WHAT WE OFFER ...**

ORDER ONLINE AT [WWW.SERVICESTRUCKS.COM](http://WWW.SERVICESTRUCKS.COM)

PRICES SUBJECT TO CHANGE.

# Rugged. Durable. Economical.

For maintenance & finishing, crown work, slope work, or paving! Slope Meters are typically mounted on the dash in the operator's view and will give fast, accurate readings for any slope. The Slope Meter enables the operator to construct true slopes without waves.



**SLOPE  
METER, INC.**



### SLOPE METER NO. 1

Used for all slope and crown construction. The figures shown on the scale represent slope. For example, when the indicator ball is over number "8", it indicates an "8-to-1" slope. The small triangles (shown between 0 and 8) represent degrees, for reference purposes. Slope-Meter "No. 1" is widely used on motor graders, bulldozers, and similar equipment.

PART# 5S0002  
**\$199<sup>99</sup>**



### SLOPE METER NO. 2

Used to determine "percent of grade" and is calibrated to read from .00 to .12 (0-12%). The "No. 2" aids the operator and speeds work on motor graders, asphalt pavers, wheel ditches, tunneling machines, and other equipment where exacting specifications are required.

PART# 5S0003  
**\$199<sup>99</sup>**



### STEEP SLOPE METER

Calibrated in percentage of grade from 0 to 50%. A major use for this meter is in all areas where a steeper slope reading is needed. This product works well on bulldozers and similar equipment.

PART# 5S0004  
**\$199<sup>99</sup>**

### BULK CAB FOAM

Bulk cab foam with perforations, 64 holes per square inch.

- 1" Thick
- 54" Wide
- Sold by the yard (36')

Part #	Description	Price
8K0004	Black	<b>\$79<sup>50</sup></b>
8K0005	Sailcloth Tan	<b>\$79<sup>50</sup></b>



### BULK FLOOR MAT

High-quality floor mat made of super-durable, compressed foam rubber material.

- 3/8" Thick
- 60" wide
- Sold by the yard (36')
- Black

PART# 8K0002  
**\$57<sup>99</sup>**



### OFF-ROAD EQUIPMENT MASTER COMPLETE MULTI-SET KEYS

Contains 66\* of the most popular keys for off-highway machines. Keys for these and more makes: ASV, Bobcat, Case, Caterpillar, Daewoo, Doosan, Ford, Gehl, Hitachi, Honda, Hyster, Hyundai, JCB, John Deere, Komatsu, Massey, and more!

PART# 9D0157  
**\$152<sup>99</sup>** \*number may vary slightly as keys are constantly revised/added per customer demands



### 3830 SNOW PLOW LIGHT SET

SAE/ECE approved for on-road and off-road vehicles. The clear glass lens and free-form reflector provide ideal road illumination in an innovative but rugged and durable design. Along with a pedestal mounting configuration, this light incorporates a moisture-eliminating breather, parking light, and a side repeater. Includes two lights, left and right side.



- Aluminized thermal grade plastic housing
- Horizontal orientation, pedestal mounting
- Integrated 6-pin DT connection
- Bulbs in H4 12v 60/55w

PART# 3A0065  
**\$249<sup>95</sup>**

### COMPACT BACK-UP ALARM

102 dB. For Medium/High Noise areas. Mounts on 3" to 3.35" centers. Compact size and universal mounting bracket maximized location options. Self grounding with stud terminal connections. Sealed in epoxy for protection against dust, moisture and vibration. OEM Crossover: CAT 1612539, JD KV18230, Preco 250, Ecco 530.



PART# 5T0057  
**\$35<sup>51</sup>**

ServiceMate

### SELF-ADJUSTING BACK-UP ALARM

97-112 dB. For Medium/High Noise areas. Mounts on 6" centers. Manually adjusts to 5 decibels above the ambient noise, up to 112 dB. 12/24 VDC. OEM Crossover: CAT 3T1815, JD AT78534, Komatsu 736131C, etc. 24 month warranty.



PART# 5T0052  
**\$169<sup>04</sup>**

ServiceMate

### CONSTRUCTION MULTI-SET KEYS

Contains 21 of the most popular keys for construction machines. Keys for: Bobcat, Bomag, Case, Caterpillar, Doosan F900, Ford, Hitachi, Hyundai, I/R, John Deere, Kawasaki, Komatsu, Kubota, Link Belt, New Holland, "Snoopy Key", Takeuchi, and Volvo. Includes a carabiner clip!

PART# 9D0155  
**\$64<sup>49</sup>**



**WE STOCK INDIVIDUAL OEM KEYS FOR OVER 40 MAKES OF HEAVY EQUIPMENT!**

**TAKE \$10 OFF \$100!\***  
USE CODE  
**TOUGHJOBS**  
AT CHECKOUT.

\*Discount can only be used once per order. Valid on orders over \$100. Can not be applied to past orders. Some exclusions apply.





## TOPSPIN™ FULL-VIEW PRE-CLEANER

Helps extend filter life on agricultural and construction equipment!

- Mount on top of the engine intake stack; includes mounting clamp
- Centrifugal force in bowl separates up to 75% of incoming dust before it enters the engine air intake system
- Durable, lightweight, noncorrosive
- Low maintenance
- Full-view plastic bowl lets operator easily see when service is needed
- One-bolt cover retention for service; remove top nut and plastic body then empty—no tools required



Part #	Max Airflow	Dimensions					Qty	Price
		A	B	C	D	E		
6F0087	80 CFM	1.75"	5.59"	4.75"	1.72"	5.5"	1	\$63 <sup>80</sup>
6F0088	90 CFM	2"	5.59"	4.75"	1.72"	5.5"	1	\$63 <sup>87</sup>
6F0089*	110 CFM	2"	7.34"	6.19"	1.72"	7.25"	1	\$63 <sup>61</sup>
6F0090	130 CFM	2.25"	7.34"	6.19"	1.72"	7.25"	1	\$63 <sup>92</sup>
6F0091	150 CFM	2.5"	7.34"	6.19"	1.72"	7.25"	1	\$61 <sup>50</sup>
6F0092	170 CFM	3"	7.34"	6.19"	1.72"	7.25"	1	\$57 <sup>82</sup>
6F0093*	320 CFM	3"	10.63"	7.66"	1.84"	10.5"	1	\$110 <sup>23</sup>
6F0094	330 CFM	3.75"	10.63"	7.66"	1.84"	10.5"	1	\$110 <sup>23</sup>
6F0095	340 CFM	4"	10.63"	7.66"	1.84"	10.5"	1	\$110 <sup>23</sup>
6F0096*	660 CFM	4"	12.06"	8.19"	2"	11.94"	1	\$167 <sup>86</sup>
6F0097	340 CFM	4.5"	10.63"	7.66"	1.84"	10.5"	1	\$109 <sup>92</sup>
6F0098*	700 CFM	4.5"	12.06"	8.19"	2"	11.94"	1	\$167 <sup>50</sup>
6F0099	740 CFM	5"	12.06"	7.69"	2"	11.94"	1	\$175 <sup>76</sup>
6F0100	1300 CFM	6"	16.25"	10"	2.81"	15.94"	1	\$427 <sup>99</sup>
6F0101	1500 CFM	7"	16.25"	10"	2.81"	15.94"	1	\$470 <sup>38</sup>

\* Heavy Duty Option

Donaldson  
FILTRATION SOLUTIONS

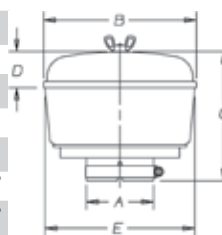

## SAFETY DECALS AND WARNING LABELS

We live in an ever changing world of laws and regulations so it's a necessity that we put the right safety decals on our machines; our selection of high-quality details will help you accommodate OSHA. Decals are cut out of solid color vinyls which is guaranteed not to fade from the elements, which means your decals are brighter, stronger, more eye appealing, and generally better for a longer duration of time.



Part #	Description	Size	Qty	Price
7B0017	Off Road Fuel	5" x 7"	5	\$33 <sup>26</sup>
7B0018	On Road Fuel	5" x 7"	5	\$33 <sup>26</sup>
7B0019	Diesel Fuel Only (Red)	2" x 3"	5	\$15 <sup>00</sup>
7B0020	Diesel Fuel Only (Black)	2" x 4"	5	\$15 <sup>00</sup>
7B0021	Hyd. Oil	2" x 8"	5	\$21 <sup>88</sup>
7B0022	Check Oil Daily	2" x 2"	5	\$12 <sup>00</sup>
7B0023	Improper jumper cable connections can cause explosion	2" x 4"	5	\$13 <sup>13</sup>
7B0024	Anti-freeze tested Degrees / Date	3-1/2" x 4-1/2"	5	\$21 <sup>88</sup>
7B0025	Read owners manual before operating	4" x 5"	5	\$28 <sup>00</sup>
7B0026	Service record	5" x 2"	5	\$15 <sup>75</sup>
7B0027	Hook w/ up arrow	2" x 3"	5	\$14 <sup>00</sup>
7B0028	Operator responsible for greasing/cleaning equipment	2" x 4"	5	\$13 <sup>13</sup>
7B0029	Operator responsible for checking water/oil daily	2" x 4"	5	\$13 <sup>13</sup>

MORE STYLES AVAILABLE ONLINE!

## CORDLESS, MOBILE, PROPANE COOLANT HEATER

The Hilton cordless engine heater has been designed to preheat all liquid-cooled engines that require preheating to start in cold weather. The Hilton heater also eliminates the need to idle diesel engines in cold weather. This heat can be used in the cab and bunk areas as well as in the engine.

Electricity from the vehicle activates the heater, allowing it to operate anywhere. The Hilton cordless engine heater is a catalytic burner, providing safe flameless heat. It uses 5.4 oz. of propane per hour, which produces 6,500 BTU. Hilton heaters are available for both 12-volt and 24-volt installation. A 20# cylinder of propane will last approximately 60 hours.

The B Series heater produces more than double the amount of heat of the LP 6500 heater, and is an excellent choice for quick engine starting and for people who want to heat the motor and have extra heat for other applications such as heating the bunk area, fuel or hydraulics.

Part #	Description	Output Per Hour	Volts	Dimensions HxD	Price
5J0002	LP 6500 Cordless Engine Heater	6500 BTU	12	12.5 in. x 5 in.	\$799 <sup>95</sup>
5J0003	LP 6500 Cordless Engine Heater	6500 BTU	24	12.5 in. x 5 in.	\$799 <sup>95</sup>

Heater comes with mounting bar, fuel pressure regulator, and a wiring harness that connects to the on/off switch. You will need to furnish the propane tank and hoses (3/4" heater hose and 1/4" flexible fuel line hose).



## AIRHAWK PLUS SEAT CUSHION

Use the Airhawk Plus Seat Cushion as a high quality flotation cushion to keep you riding in comfort while on the job. The Airhawk Seat Cushion uses fully adjustable air-filled individual cells that are controlled by an innovative air valve and pump that will distribute seating weight evenly for a more comfortable ride. Using the dry flotation technology will help reduce grievances to pressure points, which are the main source of numbness and back pain.

- Durable Black Polyvinyl material
- Breathable and stretchable nylon/lycra blend cover
- Isoflow air adjustment valve
- 19" x 19" square cushion
- Dry flotation technology
- Strong wear resistance



PART# 8K0006  
\$166<sup>99</sup>

## THE INFORMER™ AIR FILTER INDICATOR

For graduated, continuous readings

The Informer, when mounted on the air cleaner or the dashboard, provides a continuous reading whether the engine is running or is shut down. Reset button is on top. Kit includes full installation instructions and a safety filter fitting. For remote mounting, order a 6F0067 flange and a 6F0068 90° elbow.

Part #	Description	Restriction Limit	Price
6F0064	Gauge and Fitting	20" H2O/5 kPa	\$52 <sup>08</sup>
6F0065	Gauge and Fitting	25" H2O/6.2 kPa	\$51 <sup>12</sup>
6F0066	Gauge and Fitting	30" H2O/7.5 kPa	\$51 <sup>36</sup>
6F0067	Remote Mount Flange	•	\$26 <sup>00</sup>
6F0068	90° Elbow	•	\$20 <sup>27</sup>

Donaldson  
FILTRATION SOLUTIONS



## ACME SPECIALTY HEAVY DUTY MIRRORS

Our off-road mirrors are vibration-resistant either at speed or at idle, our tempered mirrors withstand 5 G-force impacts. They can be used in extreme temperature variations and provide a maximum field of view. Mirrors also feature a heavy-gauge steel backing, a minimum of 16 gauge steel.



8" X 16" CONVEX TEMPERED MIRROR  
(16.85" distance between brackets). Crossover #: CAT 5P-6876  
PART# 5T0142  
\$149<sup>64</sup>



6" X 16" CONVEX TEMPERED MIRROR  
(16.85" distance between brackets). Crossover #: Cat 5P-6871  
PART# 5T0147  
\$141<sup>65</sup>

MORE SIZES ONLINE!

# TRUCK AND TRAILER ACCESSORIES

## M-80 WARNING FLAG

Durable 18" x 18" mesh jersey flag sewn onto a vinyl welt with a flexible spreader rod to hold flag out flat. Contains no wire to scratch or cause damage to your load. For use with a magnet mount. 80 lb. minimum pull strength magnet recommended.



Part #	Color	Size	Price
5P0020	Red	18" x 18"	<b>\$8<sup>95</sup></b>
5P0021	Orange	18" x 18"	<b>\$8<sup>95</sup></b>

## M-80 MAGNET MOUNT FOR FLAGS

Hold your flag securely where you need it. Large 2-5/8" dia. chrome steel cup magnet mount. Has 80 lb. pull strength. Functional, durable and rust resistant. Includes 1/4" nylock wing nut to hold flag securely.



PART# 5P0034  
**\$10<sup>35</sup>**

## WOOD DOWEL FLAG

Quality red or orange mesh jersey 18" x 18" flag glued and stapled onto a 3/8" wood dowel.



Part #	Color	Dowel Size	Pkg	Price
5P0030	Red	5/8" x 36"	12	<b>\$66<sup>84</sup></b>
5P0031	Orange	5/8" x 36"	12	<b>\$66<sup>84</sup></b>
5P0032	Red	3/4" x 36"	12	<b>\$75<sup>24</sup></b>
5P0033	Orange	3/4" x 36"	12	<b>\$75<sup>24</sup></b>

## STRAP BANDS

7"x1"x0.065" heavy duty rubber band. Holds straps tight when not in use for easy storage. Pkg of 6.

PART# 5P0002  
**\$7<sup>50</sup>**



## TORQUEDRIVE™ STEEL OFFSET CHAIN BINDERS

The Absolute Highest Quality, Safest, Fastest, Tension Retaining Load Binder IN THE WORLD!!

Faster and safer tie down and release. Tighter chains every time.

- **Ideal for tight areas.** In confined situations, TorqueDrive™ can be 20 to 30 times faster; allowing for total powered rotation, where a manual binder may only be able to get a quarter rotation or less.
- **Powers through** dirty or neglected threads on binders. Simply adjust the torque setting on your portable drill.
- **Built to last.** Manufactured with heat treated, forged components for a long dependable life. Smooth operation due to a precision aligned worm gear assembly with grease fitting, for years of trouble free service.
- **Manufactured to WSTDA-T6 standards.** G70 Rated.
- We recommend an 18 volt cordless drill with at least 200 lbs of torque. You will need a 3/8" adapter and 3/4" socket to operate.

The ultimate for the steel hauler! Truly the best binder on the market bar none. Gets chains tighter, safely and faster than anything on the market. Store your endlinks inside the barrel when storing and they will be out of the road salt / brine and stay lubricated. Heavy / implement grade paint resistant to chipping, zinc coated, sealed gear box. You will love these!

Choose from 3 Models, Blue Line, Red Line, and Green Line.

## QUICKMOUNT WARNING FLAGS

Spring-loaded, quick-release receiver constructed of 303 stainless steel for durability and rust protection. Fast & easy installation. Comes with 18" x 18" durable mesh jersey flag that is replaceable. Flag spins freely on staff for maximum visibility. Requires bracket assembly, sold separately.



Part #	Description	Dimensions	Price
5P0009	Red Flag Assembly	18" x 18"	<b>\$39<sup>99</sup></b>
5P0010	Orange Flag Assembly	18" x 18"	<b>\$39<sup>99</sup></b>
5P0011	Replacement Flag Red	18" x 18"	<b>\$7<sup>65</sup></b>
5P0012	Replacement Flag Orange	18" x 18"	<b>\$7<sup>65</sup></b>

## QUICKMOUNT MOUNTING BRACKET

Our heavy duty stainless steel mounting bracket for quickmount flag assembly. Comes with stainless steel hardware. Mounts flag at either a 45° or 90° angle. Stud kit included. The best mount available for the job.



PART# 5P0016  
**\$21<sup>99</sup>**

## TURBO SAVER

Don't destroy your turbo while hauling your equipment.

Wind can cause your turbo to spin. Due to lack of lubrication the bearings can be ruined. With Turbo Saver, the wind cannot turn the turbo. This cuts down on expensive repairs and downtime. Turbo Saver is reusable and eliminates the need to use duct tape or rags in the exhaust pipe.



Part #	Description	Price
5T0260	7" Original	<b>\$39<sup>99</sup></b>
5T0261	12" Industrial	<b>\$44<sup>99</sup></b>

## GROMMET WARNING FLAGS

Durable mesh jersey flag 18" x 18" with #2 brass grommets for universal attachment. Reliable and a long service life for minimal cost.



Part #	Color	Size	Pkg	Price
5P0024	Red	18" x 18"	12	<b>\$44<sup>16</sup></b>
5P0025	Orange	18" x 18"	12	<b>\$44<sup>16</sup></b>

## EZ-HOOK WARNING FLAG

Durable red or orange mesh jersey sewn into a flexible vinyl welt with a heavy bungee. Resists ripping and fading. Makes flagging your load fast and easy. This is the premiere flag on the market and is extremely versatile. Available in 2 sizes and colors.



Part #	Color	Size	Price
5P0022	Red	18x18"	<b>\$9<sup>00</sup></b>
5P0023	Orange	18x18"	<b>\$9<sup>00</sup></b>
5P0037	Red	24x24"	<b>\$11<sup>25</sup></b>
5P0038	Orange	24x24"	<b>\$11<sup>25</sup></b>

## OVERSIZE LOAD SIGNS



Bold 12" black letters hand silk screened on yellow background. Easy to clean warning signs are available in two styles:

- **Grommet Style:** Six #2 brass grommets for easy attachment.
- **EZ Hook Style:** Durable vinyl coated poly-mesh material allows airflow. Sewn into a strong flexible welt with heavy 18" bungee on each end. Wrap around double stitch border. Easy to attach.

Part #	Description	Dimensions	Price
<b>GROMMET STYLE</b>			
5P0003	Oversize Load	18" x 84"	<b>\$27<sup>95</sup></b>
5P0005	Long Load	18" x 84"	<b>\$27<sup>95</sup></b>
5P0035	Wide Load	18" x 84"	<b>\$27<sup>95</sup></b>
5P0007	Oversize Load Escort	14" x 60"	<b>\$26<sup>95</sup></b>

## EZ HOOK STYLE

5P0004	Oversize Load	18" x 84"	<b>\$31<sup>95</sup></b>
5P0006	Long Load	18" x 84"	<b>\$31<sup>95</sup></b>
5P0036	Wide Load	18" x 84"	<b>\$31<sup>95</sup></b>
5P0008	Oversize Load Escort	14" x 60"	<b>\$29<sup>95</sup></b>

## BATTERY POWERED LED PERSONAL SAFETY LIGHTS

360° LED beacon in amber operates for 300-400 hours on 2 D batteries (not included). Features 24 ultra bright LED's and 60 triple FPM.

- Photocell control for night time use
- Includes magnet mount base and carrying strap
- Size 4-1/8 D X 4-3/4" H
- Optional "L" bracket for logging or pole applications available
- 90 day warranty

Part #	Description	Qty	Price
5T0262	Strobe Light	1	<b>\$74<sup>44</sup></b>
5T0263	Bracket	1	<b>\$27<sup>58</sup></b>





# Protect Your Fleet.

Let us solve your under-inflation and flat tire problems. Multi Seal® – superior science, superior sealants.



## MULTI SEAL® PRO HD 2500™ TIRE SEALANT

Your heavy tires routinely endure heavy punishment. They encounter 'tire killers' such as jagged rocks, broken concrete, rebar, scrap metal, welding rods, nails and other hazardous objects. MULTI SEAL® PRO HD 2500™ Formula allows your tires to withstand the rigors of heavy, continuous use. Your tires, drivers and equipment are protected from job-stopping flats due to slow leaks around the rim as well as air loss through punctures – from pinholes to serious punctures (up to 3/4" dia. in the tread area). One treatment of PRO HD 2500™ Formula will reduce flats by up to 95%, keeping you rolling safely, thereby saving you money and lost hours. Easily installed, PRO HD 2500™ Formula lasts the life of the tire and is easily washed out at the end of the tire's life.

Part #	Sizes	Price
6N0003	(4) 1 Gallon Bottles	\$266 <sup>00</sup>
6N0006	1 oz. Pump Pack for 1 Gal. Bottle	\$11 <sup>50</sup>
6N0004	5 Gallon Bucket	\$329 <sup>00</sup>
6N0005	Extra Heavy Duty Pump for 5 Gal. Bucket	\$120 <sup>00</sup>

**Use for heavy equipment:** Backhoes, Articulated Loaders, Road Graders, Ag Equipment—Tractors, Mowing machines, Harvesters, Haul trailers, Skid Loaders, Cranes, Trucks, and more!



## MULTI SEAL® FLATOUT TIRE SEALANT

FlatOut™ is a one-time tire sealant that prevents flats due to punctures up to 1/2" and stops slow leaks around the bead or valve stem or due the natural porosity of the tire. It is made of synthetic TangleTek™ fibers including KEVLAR™ and unique DamRight™ fillers suspended in our special Never-Settle™ base fluid (non-adhesive, non-toxic and freeze-resistant). When a puncture occurs, escaping air forces FlatOut™ into the wound creating an airtight fiber jam. Think beaver dam but with the fibers and fillers forming an amazingly durable plug! And, it's proven, having been used in Military and industrial applications for decades! **Install now for 24/7 protection: Seals puncture after puncture for 10+ years!**



### QUICKSTRIKE™ ON-ROAD

Great for Travel Trailers, Boat Trailers, Horse Trailers, Toy Haulers, Cargo Trailers, Utility Trailers and more. (8) 32 oz. bottles.

PART# 6N0007  
**\$150<sup>00</sup>**

### QUICKSTRIKE™ OFF-ROAD

Great for Lawn Mowers, UTVs, ATVs, Fat Tire Bikes, Dirt Bikes, Small Tractors, Wheelbarrows, Wood Chippers, Snow Blowers and more. (8) 32 oz. bottles.

PART# 6N0008  
**\$150<sup>00</sup>**

### SPORTSMAN

Great for ATVs, UTVs / Side-by-Sides, Golf Carts, Dirt Bikes, Off-Road-Only Jeeps and more. (8) 32 oz. bags.

PART# 6N0009  
**\$180<sup>00</sup>**

## FLARETITE STANDARD CARBON STEEL SEALS SAMPLE KIT

This permanent, "Leak-Free" connection exceeds the performance of today's ORFS fittings, and at significantly lower cost. It is a metal stamping, designed with multiple, concentric sealing rings and coated with a dry-to-the-touch, baked-on Loctite™ sealant. When inserted into a fitting, the concentric rings form multiple seals down the face of the flare, while the Loctite™ coating fills minor imperfections, dramatically increasing the integrity of the fitting.

- 304 Stainless steel seal with Loctite Vibra Seal coating.
- Rated for -40° to 300°F temps and all common gases & fluids.
- 61 seals, 1/4" thru 2", fits JIC 37° fittings

PART# 1H0002  
**\$299<sup>96</sup>**



## 293 PC. BACK-UP RING KIT

This 293 piece kit contains 36 of the most popular size "Parback®" Style Dished Cross Section back-up rings. Molded of 90A Durometer Buna-N rubber, they stretch for installation and return quickly to their original size. SIZES CORRESPOND TO O-RING NUMBERS. Your shop and service truck should not be without this handy kit.

36 sizes, 293 O-rings

PART# 4J0007  
**\$129<sup>72</sup>**



## DAKOTA SHINE KITS

Dakota Shine is a unique and patented product that will restore the color, lustre and value to faded and oxidized surfaces like paint, decals, plastics and more. Dakota Shine is a ready-to-use product that requires no mixing.

**Each kit includes:** Dakota Prep, Dakota Shine Aerosol, Dakota Shine Scrub Pads and Instructions. Industrial kits also include Dakota Shine in 1 Gallon containers.



Part #	Description	Coverage	Price
4D0001	Pro Kit (Case of 2)	100 SF	\$199 <sup>95</sup>
4D0002	Small Industrial Kit	400 SF	\$327 <sup>95</sup>
4D0003	Medium Industrial Kit	800 SF	\$549 <sup>95</sup>

\*A medium sized pickup or tractor is approx. 100 sq. ft.

## BRITEPLUS MX

BritePlus MX is the choice for superior cleaning of raw or brushed surfaces. Clean stained and oxidized aluminum.\*

BritePlus MX cuts through yellow stains, black streaks, haze and other discolorations. It cleans and brightens faded and oxidized aluminum. It even works great on painted surfaces.

BritePlus is a proven cleaner for your toughest jobs, like over-the-road trailers, SUV wheels, engine compartments, and more. A 2.5 gallon container is normally enough product to clean a 20 ft. trailer twice.

Part #	Description	Price
4D0006	BritePlus 2.5 Gallons	\$65 <sup>95</sup>
4D0007	BritePlus 5 Gallons	\$103 <sup>95</sup>

\*Can dull and/or whiten polished surfaces, use AlumiWash for those applications



## ALUMIWASH RTU

Choose AlumiWash RTU (Silver BritePlus MX) on polished surfaces. Maintain new or polished aluminum and stainless steel.

AlumiWash is a proven cleaner for very reflective, high-shine, and polished metal surfaces - like newer cattle trailers, tankers, polished wheels, and tanks. Our most gentle formulation - will not harm polished surfaces.

Apply with a standard weed sprayer or a bucket and soft-bristled brush. No mixing required!

Part #	Description	Price
4D0004	Silver BritePlus 2.5 Gallon	\$65 <sup>95</sup>
4D0005	Silver BritePlus 5 Gallons	\$103 <sup>95</sup>



## THREAD CHECKER

Each size has a bolt and nut thread checker on the same gauge. Thread sizes are permanently stamped onto each gauge. Unit comes with a wire cable with loop on each end for convenient hanging. The individual gauges rotate freely on the wire cable for fast verification. Hardened steel.

**INCH SIZE**  
SAE 1/4" - 1-1/2"  
Clear zinc plated

PART# 2T0002  
**\$43<sup>00</sup>**

**METRIC SIZE**  
Metric 3-24  
Black oxide finish

PART# 2T0003  
**\$43<sup>00</sup>**

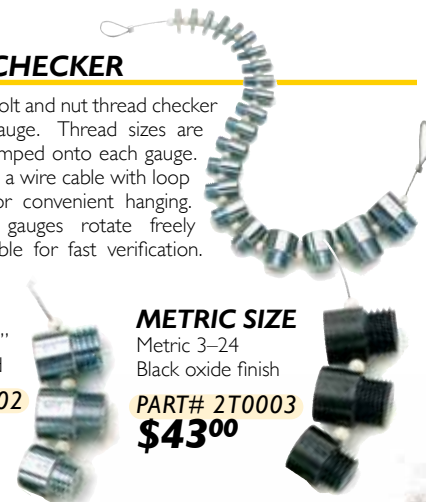



# Downtime Costs Money.

For as long as heavy equipment has been a crucial part of job success - equipment has broken down on a job because of a bad o-ring. Delays cost tens of thousands of dollars in lost time because of a part that costs a few dollars. We sell high-quality OEM o-ring kits that will ship within 24 hours, preventing your low-cost part failures from becoming big-dollar delays!



## CATERPILLAR® MEGA O-RING KIT

This double-sided mega kit contains Caterpillar kits: 4C-4788, 4C-4784, 4C-5859, 4C-8253, 9S-3135 and 4C-4782.

### Contents of Kit:

- 8 sizes Orfs o-rings
  - 11 sizes SAE flange o-rings
  - 13 sizes standard Boss o-rings
  - 10 sizes metric port o-rings
  - 9 sizes d-rings for XT5&6 flange connections
  - 32 sizes yellow silicone o-rings
- 83 Sizes, 633 O-rings, 45 D-rings**

PART# 9Q0005  
**\$517<sup>50</sup>**



## CATERPILLAR® FLAT FACE KIT

This compact single-sided kit contains high-pressure, Ors (flat face) o-rings for Caterpillar equipment, which replaces Caterpillar kit #4C-5859.

### Contents of Kit:

- 8 sizes Ors (flat face) o-ring
- 8 Sizes, 265 O-rings**

PART# 9Q0007  
**\$49<sup>20</sup>**



## CATERPILLAR® D-RING KIT

This single-sided, high-pressure kit contains D-rings for Caterpillar XT 5 and 6 flange connections, which replaces Caterpillar kit #4C-4784.

### Contents of Kit:

- 9 sizes D-rings
- 9 Sizes, 80 D-rings**

PART# 9Q0009  
**\$173<sup>25</sup>**



## BOBCAT® O-RING KIT

This single-sided kit contains low- and high-pressure o-rings for Bobcat equipment, including a large assortment for hose end fittings.

### Contents of Kit:

- 8 sizes / 96 brown Viton o-rings
  - 14 sizes low- and high-pressure o-rings
- 22 Sizes, 250 O-rings**

PART# 9Q0002  
**\$168<sup>00</sup>**



## KOMATSU MEGA O-RING KIT

This two-sided, all high-pressure mega kit covers a wide range of part numbers for Komatsu equipment. Also included is a full o-ring assortment for Parker Hose fittings.

### Contents of Kit:

- 10 sizes 21T Green Excavator Series o-rings
  - 26 sizes 07000-1 Series o-rings
  - 5 sizes 07002-1 Series o-rings
  - 25 sizes Boss, flange, flat face o-rings for Parker Hose fittings
- 66 Sizes, 567 O-rings**

PART# 9Q0028  
**\$440<sup>00</sup>**



## KOMATSU SUPER O-RING KIT

This double-sided super o-ring service kit is a replacement for Komatsu kits: 1400686H91, 1400688H91, 1400689H91, 1400690H91, 1400692H91 and 1400693H91.

### Contents of Kit:

- 19 sizes 07000-1 series o-rings
  - 5 sizes 02896 series o-rings
  - 8 sizes 07002 series o-rings
  - 22 sizes 07000-7 series o-rings
  - 20 sizes 07000-E series o-rings
  - 20 sizes 07000-F series o-rings
  - 10 sizes 21T series o-rings
- 104 Sizes, 1002 O-rings**

PART# 9Q0027  
**\$658<sup>00</sup>**



## HITACHI MEGA O-RING KIT

This two-sided mega kit contains low- and high-pressure o-rings for EX100 through EX3500 Hitachi Excavators. (Replaces Hitachi small, medium and large o-ring kits, along with a variety of other commonly used o-rings.)

### Contents of Kit:

- 46 sizes low- and high-pressure o-rings
  - Large assortment of Viton o-rings for high-temp. use
- 46 Sizes, 332 O-rings**

PART# 9Q0003  
**\$449<sup>50</sup>**



Notice. All manufacturers names, numbers, symbols and descriptions on the Q-Pac O-Ring Kits are used for reference purposes only, and it is not implied that any part listed is the product of the original equipment manufacturer.

## JOHN DEERE® INDUSTRIAL O-RING KIT

This double-sided, industrial o-ring kit contains a large assortment of high- and low-pressure o-rings for John Deere equipment, which replaces John Deere kit #AT130208, and also includes John Deere kit #AT85197 and #TY16429.

### Contents of Kit:

- 8 sizes Ors (flat face) o-rings
  - 13 sizes standard Boss o-rings
  - 59 sizes various high and low-pressure o-rings
- 80 Sizes, 713 O-rings**

PART# 9Q0015  
**\$465<sup>00</sup>**



## JOHN DEERE® MASTER HOSE END O-RING KIT

This two-sided, all high-pressure master hose end kit contains John Deere kits #AT85197, #AT196833, #TY16430, #TY16429 and #TY16431.

### Contents of Kit:

- 8 sizes Ors (flat face) o-rings
  - 10 sizes SAE split-flange o-rings
  - 13 sizes standard Boss o-rings
  - 9 sizes metric port o-rings
  - 12 sizes 24° cone o-rings
- 52 Sizes, 545 O-rings**

PART# 9Q0016  
**\$320<sup>00</sup>**



## JOHN DEERE® HOSE END O-RING KIT

This single sided, industrial hose end kit contains high-pressure o-rings for use on John Deere equipment and replaces John Deere kits #AT85197, #TY16429 and #TY16430.

### Contents of Kit:

- 8 sizes Ors (flat face) o-rings
  - 10 sizes SAE Flange o-rings
  - 13 sizes Boss o-rings
- 31 Sizes, 427 O-rings**

PART# 9Q0017  
**\$198<sup>00</sup>**



## JOHN DEERE® FLAT FACE O-RING KIT

This compact single-sided kit contains all high-pressure, Ors (flat face) o-rings for John Deere equipment, which replaces John Deere kit #AT85197.

### Contents of Kit:

- 8 sizes Ors (flat face) o-rings
- 8 Sizes, 265 O-rings**

PART# 9Q0026  
**\$49<sup>20</sup>**



## VOLVO INDUSTRIAL O-RING KIT

This two-sided mega kit contains Volvo kits #15155158, 11708294, #63049, #14511214 and other high-usage standard and metric o-rings.

### Contents of Kit:

- 7 sizes Ors (flat face) o-rings
  - 10 sizes 37° o-rings
  - 9 sizes Boss o-rings
  - 6 sizes flange o-rings
  - 34 sizes standard & metric o-rings
- 75 Part #'s, 864 O-rings**

PART# 9Q0048  
**\$426<sup>25</sup>**



**OVER 40 KITS AVAILABLE ONLINE!**



# SHOP EQUIPMENT AND SERVICE TOOLING

## AIR COMB™

Innovative Air Comb™ blows air at a 90° angle. Patent-pending air guns have a multi-port nozzle with five holes on the top of the wand that maximize pressure and volume at a 90° angle. Provides a focused, high-pressure output that cleans hard-to-reach areas. Fit inside oval and cylindrical air filters, radiators or AC condensers. Choose from 12", 24", 36", or 48" lengths. Imported.

Part #	Description	Price
7N0514	12" Air Comb™	<b>\$38<sup>99</sup></b>
7N0515	24" Air Comb™	<b>\$43<sup>99</sup></b>
7N0516	36" Air Comb™	<b>\$50<sup>99</sup></b>
7N0517	48" Air Comb™	<b>\$56<sup>99</sup></b>

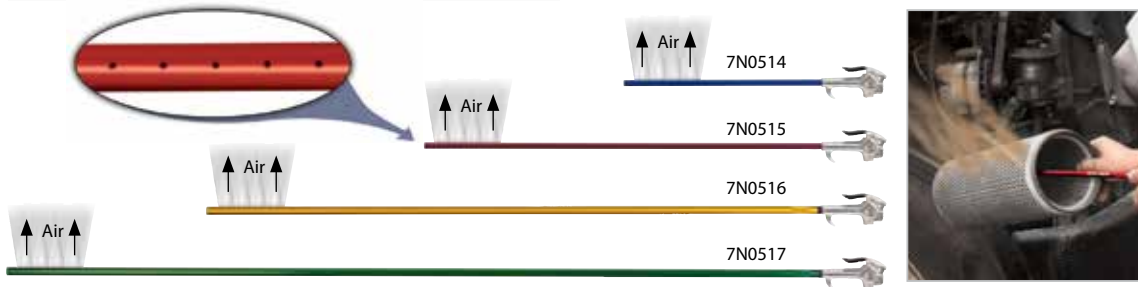

## AIR FILTER BLASTER MAX

Air Filter Blaster is a new patented method for air filter cleaning that dramatically reduces air filter replacement and fuel usage on motorized equipment.

The system requires no expensive add-ons or external devices – it requires only a simple source of compressed air. Ports within the Air Filter Blaster's centrifugal forced air induction chamber create a shaft rotation that uniformly vibrates and discards dirt and particles from the inside of the air filter outwards.

The portable unit is designed to be taken directly into the field or on the road with a service truck or for dedicated use on a single piece of movable equipment. Cleans filters up to 25" tall. Requires a compressor with 90 psi capabilities.

### Includes:

- One 6" rotor head to fit the most common filters
- Filter Blaster Induction chamber
- Protective hard case

**PART# 8A0002**  
**\$299<sup>00</sup>**

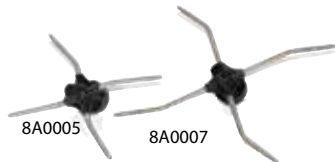

### ADDITIONAL ROTOR HEADS

Part #	Description	Price
8A0004	3" Rotor Head - For filters w/ inside dia. 3-4-1/2"	<b>\$67<sup>50</sup></b>
8A0005	4-1/2" Rotor Head - For filters w/ inside dia. 4-1/2-6"	<b>\$67<sup>50</sup></b>
8A0006*	6" Rotor Head - For filters w/ inside dia. 6-9"	<b>\$67<sup>50</sup></b>
8A0007	9" Rotor Head - For filters w/ inside dia. 9" +	<b>\$67<sup>50</sup></b>

\*Comes standard with Portable units

## LEACHROD BLADE LIFT TOOL

The Blade Lift Tool was designed to effortlessly and safely change the blades on dozers, road graders, snow plows, v plows and swing arms.

The Leachrod Tool makes it quick and easy for a single person to safely change the wear edges on maintenance vehicles. Simply insert the Leachrod pins through the blade. Lift and align pins on machine and slide into position.

### Reasons You Need The Leachrod

- Helps eliminate risky lifting techniques on cumbersome edges.
- Gives you control over heavy blade equipment without straining your back - reduces back injuries.
- Makes your workload more efficient, reducing the time it takes to perform a motor grader or snow plow blade exchange— saving time and money.

Snow Plow, Dozer, Grader - Comes w/ quick pin release to enable handle to bend at a 60° angle; allows for addn'l clearance.

**PART# 1P0012**  
**\$2,050<sup>00</sup>**



## SLIDE SLEDGE® HAMMER TOOLS

The powerful Slide Sledge® Heavy Equipment™ Hammer reduces dangerous, time-consuming hammer and chisel jobs to a one-man, one-tool operation. The linear motion of Slide Sledge® focuses power for precision impact to drive pins and make other tough maintenance jobs easier, faster and a whole lot safer.

- Safer and more accurate
- Reduces downtime
- Increases productivity
- Extremely powerful
- Versatile



### HEAVY EQUIPMENT™

Ideal for most standard applications. Compact 30" is great for fitting into tight areas.

Part #	Description	Weight	Price
8P0002	30" Heavy Equipment™	9 lbs	<b>\$579<sup>79</sup></b>
8P0003	46" Heavy Equipment™	13 lbs	<b>\$652<sup>79</sup></b>

### HEAVY EQUIPMENT™ BMF

Larger diameter BMF series delivers Biggest Maximum Force for your toughest applications.

Part #	Description	Weight	Price
8P0004	30" Heavy Equipment™ BMF	14 lbs	<b>\$690<sup>79</sup></b>
8P0005	46" Heavy Equipment™ BMF	21 lbs	<b>\$799<sup>99</sup></b>

**SLIDE SLEDGE® TIPS AND ACCESSORIES AVAILABLE ON OUR WEBSITE!**

## DUMP BRACE®

### Universal Dump Truck Safety Locks

Chain-less clamping mechanism that allows a simpler, faster, and more secure installation process. Built to minimize the amount of time the raised dump bed is unsupported during installation, it takes just one person approximately 60 seconds to install a pair of braces.

- 21" H x 6" W x 12.75" L
- Maximum Capacity (pair): 80,000 lbs
- Overall Weight: 40 lbs each
- Fits 3-1/2" to 5" standard flange width
- Sold as a pair

**PART# 9U0035**  
**\$999<sup>00</sup>**



## DUMP-LOK®

Prevent Injuries and Fatalities from Unsecured Dump Beds. DUMP-LOK is a unique and simple solution that safely secures the dump bed, preventing injuries. DUMP-LOK holds dump beds at angles higher than most dump truck manufacturer body props, giving workers safe access to more areas underneath the dump bed. Sold as a pair.

Wide Top Part #'s below, also available with Flat Top and Notched Style. Call to order.

Part #	Description / Max Weight	Price
9U0007	UDL-105 for 4.75" Max Truck Frame, 50,000 lbs	<b>\$1,250<sup>00</sup></b>
9U0009	UDL-106 for 6" Max Truck Frame, 50,000 lbs	<b>\$1,250<sup>00</sup></b>
9U0014	UDL-1075 for 7" Max Truck Frame, 50,000 lbs	<b>\$1,250<sup>00</sup></b>
9U0016	UDL-108 Unlimited Truck Frame, 75,000 lbs	<b>\$3,400<sup>00</sup></b>



# JOB SITE TOOLS AND EQUIPMENT

## HASTINGS NON-CONDUCTIVE FIBERGLASS TELESCOPING MEASURING RODS

Designed for quick, one-man measurements of vertical or horizontal distances up to 50'. Extends for measurement, retracts to 69" for storage. Measurements are read directly, no calculations are necessary. Non-conductive. Made of tough, durable fiberglass. Available in English or Metric. Features a Voltage Rating of 100,000 volts per foot per 5 minutes. Excellent for measuring heights of trees, power lines, ceilings, and dimensions of woodpiles. Can also be used to measure horizontal surfaces, such as width of streams or distance between tree seedlings.

### ENGLISH RODS

Graduated in feet, inches, and half-inches. All figures and graduations in black. Background color is yellow.

Part #	Description	Price
3H0089	25' Extended, 69" Retracted	\$400 <sup>19</sup>
3H0090	30' Extended, 69" Retracted	\$503 <sup>19</sup>
3H0091	35' Extended, 69" Retracted	\$609 <sup>38</sup>
3H0092	40' Extended, 69" Retracted	\$759 <sup>55</sup>
3H0093	50' Extended, 69" Retracted	\$970 <sup>44</sup>

### METRIC RODS

Graduated in meters, decimeters, and centimeters. Meter figures in red. All other figures and graduations are black. Background color is yellow.

Part #	Description	Price
3H0094	7.5m Extended, 1.75m Retracted	\$400 <sup>18</sup>
3H0095	10.5m Extended, 1.75m Retracted	\$609 <sup>38</sup>
3H0096	12m Extended, 1.75m Retracted	\$807 <sup>98</sup>
3H0097	15m Extended, 1.75m Retracted	\$931 <sup>09</sup>



### CARRYING CASE

Water-repellent. Velcro® closure.

PART# 3H0098  
**\$40<sup>30</sup>**

## MAGNA-TRAK® MAGNETIC LOCATORS

High impact plastic case is water-resistant, lightweight and epoxy sealed. On/Off, Volume, and Sensitivity controls. "High-Tech" magnetic toroidal sensors and electronic balancing circuitry.

- Length: 42-3/4"; weight: 3 lbs./1.3kg
- Waterproof up to housing; water-resistant housing
- Easy access battery compartment
- Strong, lightweight aluminum tube with durable hard rubber tie

### MODEL MT100

Features: Sensitivity control, volume control, LCD digital display, and low battery indicator.

PART# 2D0231  
**\$591<sup>39</sup>**

CST/berger

### MODEL MT202

Features: Erase feature, power line indicator; sensitivity control, volume control, LCD digital display, low battery indicator, and analog bar graph.

PART# 2D0235  
**\$648<sup>49</sup>**



## SPECTRA PRECISION® LASER LEVEL LL500

The Spectra Precision® LL500 Laser Level is a one-person leveling system designed for longer range measurements across your entire site.

### Features:

- 1,600 ft (500 m) working diameter which increases productivity by reducing the need for multiple set-ups on a large job site.
- Self-leveling with built-in 'out-of-level' shut off that maintains accuracy over the entire work area, and minimizes errors.
- High accuracy laser; 1/16 in. per 100 ft. (1.5 mm per 30 m) with temperature compensation provides highly stable, repeatable accuracy even under large temperature changes.
- Visible 'spotting' beam for determining receiver mounting placement making it faster to find the on-grade position.

### Applications:

- Checking/setting elevations, concrete forms, footings, and foundations for medium to large commercial jobs.
- Excavating, digging footings, and septic tanks.
- Sub-base leveling with skid steer loaders.
- Longer range machine control applications.

### MODEL LL500

Includes: LL500 Laser Level with HL700 Laserometer; Rod Clamp with Bubble Vial, Alkaline Batteries, Case

PART# 7S0005  
**\$1,377<sup>60</sup>**



## MARKING WHISKERS™

6" Marking Whiskers™ are an alternative marking choice for survey and construction sites, underground utility locating and many other uses. Virtually indestructible, these APWA color-coded Marking Whiskers™ spring back up when run over by lawn mowers, graders and heavy equipment. They are easily and conveniently attached to wood stakes or to 60-penny nails (not included). Use them alone or in conjunction with other marking products. Sold as a case of 1,000. Priced per case.

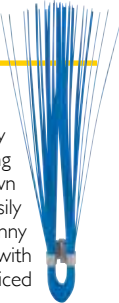

Part #	Color	Qty	Price
4Q0004	Standard Blue	1,000	\$159 <sup>89</sup>
4Q0005	Standard Green	1,000	\$159 <sup>89</sup>
4Q0007	Standard Red	1,000	\$159 <sup>89</sup>
4Q0009	Standard Yellow	1,000	\$159 <sup>89</sup>
4Q0010	Orange PreGlo	1,000	\$159 <sup>89</sup>
4Q0011	Pink PreGlo	1,000	\$159 <sup>89</sup>

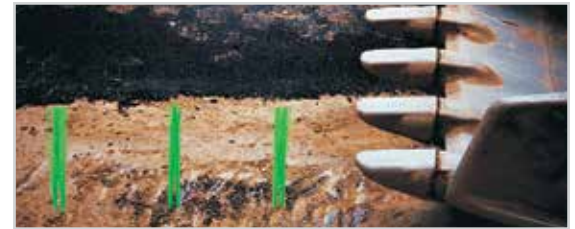

## SPECTRA PRECISION® PIPE LASERS

Rugged pipe lasers built for lasting performance, reliability, and repeatability. Use for installation of gravity flow sanitary pipelines, storm sewer pipelines, pipe jacking, and/or tunnel boring.

### Features:

- Rugged design is built for long lasting performance and reliability in the destructive underground environment. The DG813 is completely waterproof and its' shorter length fits into tight inverts in the manhole.
- DialGrades feature the largest automatic self-leveling range in the industry providing quick, easy setups.
- The DG813 features Line Alert where the beam flashes to notify you that the setup line has been disturbed, eliminating the necessity of rework.
- A full range of setup accessories and power options are available and are easy and straightforward to use.
- Maximum legal strength red laser beam and pipe targets with optical elements to enhance beam brightness make the beam easily visible in a variety of conditions.
- Remote controls for line and power included, DG813 remote control is full function with grade control and Line Set/Check function.



### MODEL DG813

Includes: DG813 Laser; 1248 trivet plate 8 inch (200mm), RC803 IR/Radio Remote Control, SF803 Spot Finder w/pole adapter & target plate, 956 target, ST802 Transporter; NiMH battery pack and charger

PART# 7S0014  
**\$4,788<sup>00</sup>**



**WE CARRY THE LATEST IN LASERS AND RECEIVERS FROM SPECTRA PRECISION!**



# JOB SITE TOOLS AND EQUIPMENT

## RAT GUARDS

Avoid irritating and costly plugged drainage systems with stainless steel and powder coated band type Rat Guards!

### STAINLESS STEEL

- Easy to install
- Resists rust and corrosion
- Stainless steel material provides extended life cycle
- Available 4" through 24"



Part #	Size	Price
7A0033	4"	\$12 <sup>53</sup>
7A0034	6"	\$14 <sup>57</sup>
7A0035	8"	\$17 <sup>97</sup>
7A0036	10"	\$27 <sup>65</sup>
7A0037	12"	\$42 <sup>34</sup>
7A0038	15"	\$69 <sup>61</sup>
7A0039	18"	\$111 <sup>63</sup>

Larger sizes are available, give us a call!

### BAND TYPE RAT GUARD

- Easy to install
- Zinc dichromate coated mild steel resists corrosion.
- Designed to fit 6" through 24" CMP, PVC, and other similar types of pipe (not designed for corr. plastic tubing)



Part #	Size	Price
7A0056	6"	\$31 <sup>81</sup>
7A0057	8"	\$37 <sup>38</sup>
7A0058	10"	\$42 <sup>48</sup>
7A0059	12"	\$50 <sup>09</sup>
7A0060	15"	\$62 <sup>79</sup>
7A0061	18"	\$97 <sup>33</sup>

Larger sizes are available, give us a call!

## BAR GUARDS

- Fights trash/crop residue to keep intakes flowing freely
- Excellent choice in any situation where a low profile, high capacity intake is required
- Protect a pond tube from rodent entry
- Constructed of 1/4" steel for durability
- Yellow powder coated finish resists corrosion and is brighter for better visibility
- Bolts, washers, and nuts are included



Part #	Size	Price
7A0117	4"	\$32 <sup>62</sup>
7A0118	5"	\$34 <sup>48</sup>
7A0119	6"	\$37 <sup>97</sup>
7A0120	8"	\$44 <sup>27</sup>
7A0121	8" Hickenbottom	\$48 <sup>74</sup>
7A0122	10"	\$58 <sup>77</sup>
7A0123	10" Hickenbottom	\$62 <sup>93</sup>
7A0124	12"	\$71 <sup>71</sup>
7A0125	12" Hickenbottom	\$79 <sup>24</sup>

Larger sizes are available, give us a call!

## AMAZING TILE TAPE

Amazing Tile Tape makes watertight junctions and connections. Unlike other tapes of its kind, it has amazing grip and stretching capabilities, making it the best in the industry.

- Large roll that measures 2" wide x 108' long.
- Tensile strength: 20#/sq. inch
- Elongation: 230%
- Dielectric: 8800 volts
- Thickness: 8 mm
- Case of 6 rolls



PART# 7A0250  
**\$51<sup>41</sup>**

## THE SLING BAG

Holds loads up to 3,000 lbs. and is perfect for use to collect dirt or trimmings. Four sewn straps allow you to hand-carry The Sling Bag or drag it behind a tractor. It can be used to lift a balled tree, drag bags of concrete, and more! The geo-textile fabric will not mold and allows moisture to escape while holding in all contents. 7'10" x 7'10".

PART# 3H0156  
**\$88<sup>90</sup>**



## DANDY BAG®

Our patented flagship bag is designed to take a lot of hard knocks. Use the Dandy Bag with flat grates (including round) and mountable curbs to filter out all the sludgy sediment-laden storm water. The suspended solids are allowed to settle out of the slowed flow and are captured by the Dandy Bag prior to entering the inlet, ensuring your regulatory compliance performance.



Part #	Size	Price
7D0004	24" x 24"	\$54 <sup>99</sup>
7D0006	28" x 28"	\$54 <sup>99</sup>
7D0009	36" x 24"	\$54 <sup>99</sup>
7D0013	48" x 24"	\$54 <sup>99</sup>
7D0014	48" x 36"	\$54 <sup>99</sup>



## DANDY SACK®

Quality is what the Dandy Sack is all about. The incredibly strong open-top bag is specially designed to hang underneath a storm grate to expertly filter the thickest sediment-laden storm water. The suspended solids are allowed to settle out of the slowed flow and are conveniently captured by the Dandy Sack prior to entering the inlet, making the sturdy Dandy Sack a storm water must.



Part #	Size	Price
7D0035	24" x 24"	\$54 <sup>99</sup>
7D0036	36" x 24"	\$63 <sup>99</sup>
7D0037	48" x 24"	\$74 <sup>99</sup>
7D0038	48" x 36"	\$78 <sup>99</sup>



**MORE STYLES ONLINE!**

## POCKET PENETROMETER

Spring-operated penetrometer is used to measure compressive strength of soil by pushing a ground and polished 1/4" diameter loading piston into soil to a depth of .25". End area is .05 square inch. Compressive load in tons per square foot or kg per square cm is indicated by reading scale on piston barrel. Maximum reading reach is shown by friction ring. Made of anodized aluminum. Allen wrench and plastic carrying case with belt loop are included. 6-1/4" Long.

Part #	Description	Price
3H0004	Pocket Penetrometer	\$59 <sup>49</sup>
3H0005	Adapter Foot - Use with sensitive soils	\$24 <sup>64</sup>



## GEOTECHNICAL GAUGE

Holds loads up to 3,000 lbs. and iMake accurate and consistent observations every time! Features include centimeter and inches scale, roundness chart, chart for estimating percentage composition, six common Munsell® soil colors, Unified Soil Classification System (USCS), soil compaction tests for clay and sand, and size classification chart with actual sand grains from coarse to silt permanently fused to plastic card. Flexible, waterproof plastic card has nylon string for carrying convenience and measures 5" x 7".

PART# 1B0010  
**\$35<sup>54</sup>**



## MUNSELL COLOR® CHART BINDER

The Munsell Color Chart enables color classification of soils using 250 mounted color chips. Developed with the U.S. Soil Conservation Service, this guide is the industry standard. The book's light gray pages decrease sun glare.

PART# 1B0009  
**\$315<sup>43</sup>**



## SOIL COMPACTION TESTER

Long, stainless steel rod (with depth marks of 3", 6", 9", 12", 15", and 18") can be inserted to 24", allowing you to test compaction levels as far down as subsoiling depths. As you insert rod, compaction needle rotates within the stainless steel housing, indicating compaction levels in PSI (in three ranges: 0-200 PSI, 200-300 PSI and 300+ PSI) along a color-coded dial. Incremental 3" depth markings along shaft help you monitor and record changes in compaction levels at different depths. Two interchangeable stainless steel tips (3/4", 1/2"), and rugged handle.

PART# 3H0003  
**\$354<sup>70</sup>**



## TRU-CHEK® DIRECT-READING RAIN GAUGE

One side is graduated from 0.01" to 6" while the other side ranges from 0.1 mm to 150 mm. This 13" long gauge is constructed of heavy, weather-resistant plastic and features permanently marked graduations and mounting screws.

PART# 3H0078  
**\$40<sup>72</sup>**



# LIFTING AND RIGGING

## GRADE 120 TIE DOWN CHAINS FOR LOAD BINDERS

Ensure your load is always protected with Pewag's Load Binder Securement Systems.

- 58% stronger than Grade 70 allowing downsizing of chains for less weight and easier handling
- Higher wear and bending resistance for heavy applications.
- With the same dimension of chain and workload, G120 offers a safety factor of 6:1 compared to G80 with 4:1.
- Blue powder coated finish for excellent corrosion resistance and easy identification.
- Working load limit, chain size and batch code stamped on handle with 1/4" tall raised letters
- G120 meets or exceeds the following NACM/ASTM-test requirements for lifting chains: exceeds the 4:1 NACM safety factor
- Chain accessories and hooks sold separately



Technical Data:

- Hardness approx. 41 HRC
- Nominal proof stress\* 600 N/mm2
- Nominal breaking stress\* 1200 N/mm2
- Elongation min. 20%
- Heat resistance up to 400°F
- Components fatigue tested to 20,000 cycles
- Surface powder coated blue

\*calculated acc. usual definition for round steel chain



Part #	Chain Size	Working Load Limit	Breaking Load	Length	Price
IQ0036	9/32"	5,200 lbs	20,800 lbs	16 ft	\$251 <sup>02</sup>
IQ0037	9/32"	5,200 lbs	20,800 lbs	20 ft	\$265 <sup>73</sup>
IQ0038	9/32"	5,200 lbs	20,800 lbs	25 ft	\$308 <sup>42</sup>
IQ0039	3/8"	10,600 lbs	42,400 lbs	16 ft	\$361 <sup>66</sup>
IQ0040	3/8"	10,600 lbs	42,400 lbs	20 ft	\$372 <sup>33</sup>
IQ0041	3/8"	10,600 lbs	42,400 lbs	25 ft	\$434 <sup>98</sup>
IQ0042*	1/2"	17,900 lbs	71,600 lbs	16 ft	\$544 <sup>34</sup>
IQ0043*	1/2"	17,900 lbs	71,600 lbs	20 ft	\$624 <sup>96</sup>
IQ0044*	1/2"	17,900 lbs	71,600 lbs	25 ft	\$725 <sup>58</sup>

For 1/2" size chain please call to order. \*B/O until Fall 2023

## TUFLEX EYE AND EYE (EE) ROUNDSLINGS

Tuflex Roundslings are an endless synthetic sling made from a skein (continuous loop or hank) of polyester yarn covered by a double wall tubular jacket. The roundslings body can also be compared to sling webbing with the tubular jacket face yarns woven without binder yarns; this allows the core yarns to move independently within the jacket.

Tuflex EE Roundslings are a more rugged and durable Tuflex that features an additional jacket of texturized, abrasion-resistant nylon, covers the body of the standard Tuflex, forming two color coded lifting eyes. Maintains all the basic Tuflex features plus saves money by extending sling life where abrasion to sling body is a problem.

3 Options Available in Sling Lengths from 4' to 20'.



Part #	RATED CAPACITY*			Standard At Load Eye Length	Hardware Min. Dia.**	Sling Length	Price
	Vertical Choker	Basket	Eye				
<b>PURPLE COLOR</b>							
9L0046						4'	\$37 <sup>69</sup>
9L0047						6'	\$53 <sup>98</sup>
9L0048						8'	\$62 <sup>46</sup>
9L0049	2,600 lbs	2,100 lbs	5,200 lbs	2-1/4"	10"	10'	\$76 <sup>96</sup>
9L0050						12'	\$91 <sup>44</sup>
9L0051						14'	\$105 <sup>92</sup>
9L0052						18'	\$134 <sup>90</sup>
9L0053						20'	\$149 <sup>38</sup>
<b>YELLOW COLOR</b>							
9L0054						4'	\$54 <sup>29</sup>
9L0055						6'	\$78 <sup>93</sup>
9L0056						8'	\$92 <sup>08</sup>
9L0057	8,400 lbs	6,700 lbs	16,800 lbs	2-1/2"	12"	10'	\$114 <sup>00</sup>
9L0058						12'	\$135 <sup>94</sup>
9L0059						14'	\$157 <sup>84</sup>
9L0060						18'	\$201 <sup>68</sup>
9L0061						20'	\$223 <sup>62</sup>
<b>RED COLOR</b>							
9L0562						5'	\$101 <sup>18</sup>
9L0062						6'	\$106 <sup>34</sup>
9L0063						8'	\$139 <sup>18</sup>
9L0064						10'	\$171 <sup>98</sup>
9L0065	13,200 lbs	10,600 lbs	26,400 lbs	3-1/2"	14"	12'	\$204 <sup>80</sup>
9L0066						14'	\$237 <sup>62</sup>
9L0067						18'	\$303 <sup>06</sup>
9L0068						20'	\$336 <sup>06</sup>

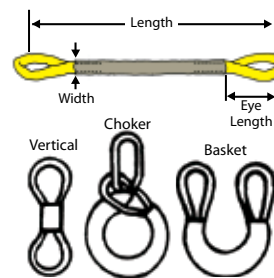

\*\* This is the smallest recommended connection hardware diameter to be used for a vertical hitch.  
\* Do not exceed rated capacities. Sling capacity decreases as the angle from horizontal decreases. Slings should not be used at angles of less than 30°.

**LARGER SIZES ONLINE!**

**TUFLEX ENDLESS ROUNDSLINGS ALSO AVAILABLE ONLINE!**



## GRADE 120 CHAIN ACCESSORIES

Alloy chain accessories for use with Grade 120 chain. Hooks and links heat treated to Grade 120 strength standards.



Self-Locking Hook



Eye Grab Hook w/ Safety Pin



### LH-G120 SELF-LOCKING HOOK

Part #	Chain Size	Working Load Limit	Price
IQ0061	9/32"	5,200 lbs	\$116 <sup>24</sup>
IQ0062	3/8"	10,600 lbs	\$159 <sup>16</sup>
IQ0063	1/2"	17,900 lbs	\$235 <sup>68</sup>

### PS-G120 EYE GRAB HOOK W/ SAFETY PIN

Part #	Chain Size	Working Load Limit	Price
IQ0064	9/32"	5,200 lbs	\$92 <sup>52</sup>
IQ0065	3/8"	10,600 lbs	\$104 <sup>49</sup>
IQ0066	1/2"	17,900 lbs	\$161 <sup>91</sup>

**MORE G120 CHAIN ACCESSORIES AVAILABLE ON OUR WEBSITE!**

## 1,500 LB. CAPACITY LOAD LEVELER

Designed to hook to a crane or hoist to handle and position automobile and light truck engines and other vehicle components. The horizontal tilt can be adjusted to compensate for off-center loads, or adjusted to a certain angle for a component being positioned. Large adjustment handle allows for quick and easy leveling of the load.

- 28.25" L x 2.375" W x 8.125" H
- 27" long chain

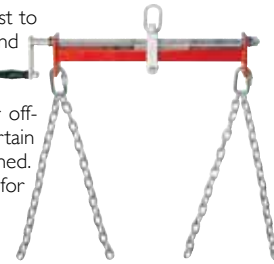

PART# 8N0025  
**\$175<sup>50</sup>**



## DIRECT CONNECT HOOKS



The quickest way to add hooks to Tuflex roundslings and web slings at your job site; no tools or extra parts needed. For Tuflex, just match the color coded hook to the same color Tuflex and you're ready to go. Rated capacities are the same for both the hook and the Tuflex.

- Rugged - Both alloy steel hook and latch are forged for superior toughness
- Web Slings - Can be used with 1" and 2" web slings (see chart below). Hook ratings should equal or exceed sling ratings as used.



Part #	Rated Capacity	WEB SLINGS	E	R	T	Price
9L0471	2,600 lbs	1 W 1 Ply	1-9/16"	3-3/8"	1"	\$90 <sup>46</sup>
9L0472	5,300 lbs	1 W 2 Ply	1-3/4"	4"	1-5/16"	\$119 <sup>55</sup>
9L0473	8,400 lbs	2 W 1&2 Ply	2-3/16"	4-5/8"	1-1/2"	\$166 <sup>42</sup>
9L0474	3,200 lbs	• •	2-3/4"	5-3/4"	1-3/4"	\$378 <sup>65</sup>





# OIL, GREASE, AND FUEL HANDLING

## GREASE JOINT REJUVENATOR®

Opens clogged grease joints and fittings quickly and effortlessly! Unique stress-proof steel tool unclogs grease joints or fittings by injecting light viscosity oil into the joint through the fitting, which loosens hardened grease. Lifetime warranty.

**How It Works:** Remove the piston and fill the tool with penetrating oil. Place the end of the tool on the grease fitting and tap the piston head with a hammer until it starts to move down into the tool body. The hydraulic pressure created by tapping on the piston forces the penetrating oil into the grease joint to the blockage.

- **Pro Kit** includes Pro Joint Rejuvenator® and a flexible 5', 4,800 psi hose extension to access hard-to-reach fittings.
- **Master Kit** includes Pro Joint Rejuvenator® and Pocket Model, along with 5', 4,800 psi flexible hose extension and extra grease coupler.

Part #	Description	Price
7N0497	Grease Joint Rejuvenator Pro Kit	\$52 <sup>29</sup>
7N0081	Grease Joint Rejuvenator Master Kit	\$71 <sup>98</sup>

Made in USA



7N0497 Rejuvenator Pro Kit



7N0081 Rejuvenator Master Kit



## SPEEDCLICK NO-SPILL™ QUICK COUPLER DRAIN SYSTEM

The Speedclick system is the quick push-on, pull-off method to drain oil safely and cleanly, and saves time too. It is the ideal drain plug for automated oil change systems. Features one click connection, solid brass construction and lifetime guarantee on workmanship and materials.

### SPEEDCLICK DRAIN PLUGS

Part #	Size	Engine	Price
7G0002	1-1/8-12UNF LB T15	CAT C27 (pass rear, driver front)	\$65 <sup>65</sup>
7G0016	3/4-16UNF LB T10	CAT, Cummins, Komatsu	\$65 <sup>65</sup>
7G0019	3/4-16UNF LB T15	CAT 3116, 3126, 3126B, C7, C9, C4 (side plug)	\$65 <sup>65</sup>
7G0021	M18x1.5mm LB T14	Case IH, CAT, Cummins, Deutz, International, JD, Mitsubishi	\$65 <sup>65</sup>
7G0026	1-5/16-12UNF LB T12	CAT C15 (some) C27 (driver rear, pass. front)	\$65 <sup>65</sup>
7G0029	1-1/2-12UNF LB T12	CAT 3304, 3306 (some), 3508	\$65 <sup>65</sup>
7G0031	1-11.5 NPT LB T12	Allison MT654, HT755DR, some HT740, CAT tapered pipe plug	\$65 <sup>65</sup>
7G0037	M16x1.5mm LB T10	CAT C3024C, C22	\$65 <sup>65</sup>
7G0043	M27x2.0mm LB T12	CAT CT11-15	\$65 <sup>65</sup>



### SPEEDCLICK DRAINERS

Part #	Description	Price
7G0003	Straight Drainer, 10" Hose	\$115 <sup>50</sup>
7G0004	45° Drainer, 10" Hose	\$115 <sup>50</sup>
7G0005	90° Drainer, 10" Hose	\$115 <sup>50</sup>

**CALL FOR ADDITIONAL SIZES!**

## HEAVY DUTY LEVER GREASE GUN

- Rugged cast iron pump head
- Precision fit / hardened plunger
- Jam-proof toggle mechanism
- Exclusive "Flip Over Follower"
- Three-way loading
- Available with or w/o 18" whip hose

Part #	Description	Price
2N0012	HD Lever Grease Gun w/ 18" hose	\$51 <sup>88</sup>
2N0013	HD Lever Grease Gun	\$42 <sup>46</sup>



## POWERLUBER® GREASE GUN

Model 1882 PowerLuber 20V Lithium-Ion Grease Gun Kit

- Stable 3-point stance keeps the tool upright and in reach
- Electronically controlled 2-speed motor
- Built-in LED illuminates dimly lit areas
- Flow meter prevents over lubrication and wasted grease
- Includes: Grease gun, charger; battery; case

PART# 2N0014  
**\$343<sup>86</sup>**



## MINI FLUID EVACUATOR

Operates on compressed air to create a powerful venturi vacuum for quickly evacuating small reservoirs. The lid unthreads for convenient emptying, and the evacuation hose is perfect for getting into those hard to reach places.

- Integrated 1.9 quart (1.8 liter) capacity reservoir
- Variable control thumb throttle

PART# 7N0023  
**\$176<sup>03</sup>**



# OPERATIONS AND PERSONNEL

## LAPTOP VEHICLE ORGANIZER

Take your office with you! This organizer features an adjustable retaining strap that attaches to the front or back of your vehicle's seat. The back compartment holds up to a 15" laptop. Other storage includes two front mesh pockets to hold note pads and pens; a middle file folder for documents; three pen holders; and a cell phone pocket. Dimensions: 12" x 15.1" x 3".



PART# 3H0167  
**\$52<sup>27</sup>**

## SCALE MASTER® PRO

The ideal tool for preparing bids and estimates from plans and blueprints. It comes with 72 built-in scales and 6 custom scales (3 each for U.S. and metric), enabling you to define any scale.

Easy to learn and use, the Scale Master Pro will save you time and reduce errors on your estimates and bids.

- Includes:
- Hard cover protective case
  - Complete User's Guide
  - Two long-life CR2032 lithium batteries
  - One-year warranty

PART# 5F0002  
**\$77<sup>96</sup>**



## "HAT SAVER" HOLDER

Spring-loaded swivel holds your hard hat securely and keeps it out of the way. Durable metal. For any hard hat or cap.

PART# 3H0176  
**\$49<sup>72</sup>**



## ULTRAFIT 27® REUSABLE EARPLUGS

Ergonomic pistol grip provides better fit and maximum performance. Triple-flange design and angled shape for easy insertion. Comfortable earplugs are washable and reusable. Dispenser boxes contain 100 pairs in poly bags. Tested to ANSI S3.19-1974.



Part #	Description	NRR*	Qty	Price
3R0371	UltraFit 27, corded	27	100 pair	\$240 <sup>11</sup>

**TAKE \$10 OFF \$100!\***  
USE CODE  
**TOUGHJOBS**  
AT CHECKOUT.

\*Discount can only be used once per order. Valid on orders over \$100. Can not be applied to past orders. Some exclusions apply.

## J.J. SCHECKEL HOODED SWEATSHIRTS

Port & Company Core Fleece Pullover Hooded Sweatshirts in Jet Black or Athletic Heather.

- 7.8-ounce, 50/50 cotton/poly fleece
- Air jet yarn for softness
- Fits true to size.
- Sizes Small through 2 XL



Part #	Description	Price
JJ101	Heather Grey Sweatshirt w/ Black Dozer	\$35 <sup>00</sup>
JJ102	Jet Black Sweatshirt w/ White Dozer	\$35 <sup>00</sup>
JJ103	Jet Black Sweatshirt w/ Yellow Dozer	\$35 <sup>00</sup>

# Inspecting is Smart Business...

THE CHECKER IS THE EASIEST TO USE, MOST ACCURATE AND COMPLETE CHECKLIST BOOK ON THE MARKET.

Properly inspecting commercial equipment is a key part of keeping workplaces safe, maintaining compliance, and improving productivity. But to ensure inspections are done as they should be, you need inspection checklists.



## INSPECTION CHECK-LIST BOOKS

Our easy-to-use Checklist Books have five features that encourage personnel to buy in to inspecting equipment properly—giving you results, not complaining and indifference.

- They are designed for specific types of equipment, with all necessary inspection items included for each particular equipment type, described with precise terminology.
- Rather than having to check off every single item, the employees doing the inspections simply circle defects and provide brief comments about them. They still have to check off each section of the Checklist, so you get time savings with no loss of accuracy. (We also provide books with traditionally formatted check-off systems for commercial road vehicles.)
- Our Checklist Books list items in circle-check sequence. We organize the inspection items on each Checklist in a way that's

practical to the people doing the inspections in the field.

- All Checklists are visually simple and clear so employees can easily locate inspection items and see what needs to be inspected.
- Each Checklist Book has the same standardized layout regardless of equipment type, so there's no confusion and no need for learning new formats.

Each Checklist Book includes:

- 150 inspection Checklists (6-7 month supply for single-shift operations)
- 2 copies for each inspection—a carbonless tear-out and a permanent copy that stays in the book so it will never be misplaced



### EQUIPMENT Book Size: 4-1/2 x 7"

Part #	Description	Price
2F0002	Excavator Equipment	\$53 <sup>99</sup>
2F0003	Backhoe Loader and Tractor Equipment	\$53 <sup>99</sup>
2F0004	Skid Steer Loader Equipment	\$53 <sup>99</sup>
2F0005	Wheel Loader Equipment	\$53 <sup>99</sup>
2F0006	Grader/Plow Equipment	\$53 <sup>99</sup>
2F0007	Dozer Equipment	\$53 <sup>99</sup>
2F0008	Hoist & Crane Equipment	\$53 <sup>99</sup>
2F0009	Mobile Cranes & Boom Trucks	\$53 <sup>99</sup>
2F0010	Crawler Crane Equipment	\$60 <sup>99</sup>
2F0011	Bridge, Jib, Gantry Cranes & Hoists	\$53 <sup>99</sup>
2F0012	Rigging/Slinging Equipment	\$53 <sup>99</sup>
2F0013	Rigging/Slinging Accessories	\$53 <sup>99</sup>
2F0014	Rigging/Slinging Combo (Equip. & Accessories)	\$74 <sup>95</sup>
2F0015	Rough Terrain Telescopic Handler Equipment	\$53 <sup>99</sup>
2F0016	Counterbalance "High-Lift" Trucks (Fork Lifts)	\$53 <sup>99</sup>
2F0017	Elevating/Aerial Work Platforms	\$53 <sup>99</sup>
2F0018	Generator Equipment	\$76 <sup>80</sup>
2F0019	Compressor and Pump Equipment	\$76 <sup>80</sup>
2F0020	Workplace, Work site "Instant Reporter" Personal Performance Tool (3 copy form)	\$53 <sup>99</sup>

### VEHICLES Book Size: 8-1/2 x 11"

Part #	Description	Price
2F0021	Dumptruck/Hauler Vehicles	\$76 <sup>80</sup>
2F0022	Truck/Equipment Transport/Flat-Bed Vehicles	\$76 <sup>80</sup>
2F0023	Concrete Delivery Vehicles	\$76 <sup>80</sup>
2F0024	Service/Utility Vehicles	\$76 <sup>80</sup>
2F0025	Fleet Vehicles (Cars, SUV's, Vans, Pick-up Trucks, Trailers)	\$53 <sup>99</sup>
2F0026	Trailer Inspection	\$60 <sup>99</sup>



2F0012

## RECORD OF ANNUAL INSPECTION REPORT

These 2-ply carbonless forms help meet applicable DOT requirements in §396.17–§396.21. Comes with a black, fade-resistant decal for trucks, tractors, trailers and dollies.



Part #	Description	Price
3K0139	Qty 5, 2-ply, continuous format, carbonless, 8-1/2"W x 11"L detached with inspection decal	\$1000

## DETAILED DRIVER VEHICLE INSPECTION REPORTS

Detailed DVIRs list specific tractor and trailer parts to help simplify inspection... drivers simply check-off parts that need repair. Book format includes key regulations printed on inside front cover to remind drivers of DOT-required procedures. Helps satisfy DOT vehicle inspection regulations §396.11 and §396.13.



Part #	Description	Price
3K0146	Qty 5 books, 2-ply, carbonless, book format, 5-1/2"W x 8-1/2"L, Includes 31 forms	\$698



**SERVICE SUPPLY AMERICA**  
21582 Hwy 62, Bellevue, IA 52031  
Ph. 563-872-5065, Fax: 563-872-5058  
[WWW.SERVICESUPPLYAMERICA.COM](http://WWW.SERVICESUPPLYAMERICA.COM)

## HOW TO ORDER

### ORDER BY PHONE

To place an order by phone, call our toll-free number 855-219-6387. Have your item numbers, credit card and shipping address ready. For your convenience, orders can be placed by phone 24 hours a day/seven days a week.

For specific questions please call us M-FR from 8-4 central at 563-872-5065.

### ORDER ONLINE

Order online by emailing your completed purchase order to: [sales@servicesupplyamerica.com](mailto:sales@servicesupplyamerica.com).

Download our order form at [www.servicesupplyamerica.com](http://www.servicesupplyamerica.com).



### HOW TO PAY

Pay for your purchase when you order using your Visa, MasterCard, American Express, or Discover card. For online orders you may also use Paypal.



### FAST SHIPPING!

We offer shipping within the 48 contiguous states with same or next day shipping available on most items. All of your items will be delivered on time and in top condition.



**SAVE \$10 OFF \$100!\***  
USE CODE  
**TOUGHJOBS**  
AT CHECKOUT.

\*Discount can only be used once per order. Valid on orders over \$100. Can not be applied to past orders. Some exclusions apply.

