



**EARTHMOVERS, EXCAVATORS, TRUCK and TRAILER**

**OVER 5,000 HIGH QUALITY PRODUCTS DIRECT!**

**855-219-6387**

**YOUR JOB'S TOUGH ENOUGH- WE'RE HERE TO MAKE IT EASIER.**

Our high-quality products were specifically chosen for those who operate, maintain, or haul heavy equipment. Our product line includes items from the following categories:

- Equipment Accessories
- Oil, Grease and Fuel Handling
- Truck and Trailer Accessories
- Lifting and Rigging
- Maintenance, Parts, Components, and Tooling
- Job Site Tools and Equipment
- Shop Equipment and Tooling
- Operations and Personnel

We're a small company, centrally located in Iowa. We pride ourselves on same-day shipping on all of our in-stock items and the same goes for the majority of our drop ship products as well. We offer only the best products from the best manufacturers to ensure your satisfaction. Give us a try, we won't disappoint!



**ORDER 24 HRS A DAY, 7 DAYS A WEEK!**

**EQUIPMENT ACCESSORIES**

**SERIES 2500 5" X 5" HALOGEN WORK LIGHTS**

The ABL 2500 series work light is a robust, off-road work light designed for demanding applications. 6"H x 5-1/2"W x 4"D. H-3 HD Bulb. Flood beam. Clear color. 4 amp current. Choose from 12V or 24V, pedestal or suspended orientation.

| 12V Part # | Orientation | Connection | Cross Reference  | Price                    |
|------------|-------------|------------|--|--------------------------|
| 3A0033     | Pedestal    | Bare leads | CAT: 9X-7779, 9X-8179; Hyundai: 21M8-01300; John Deere: AT135485, AH145563; Komatsu: 1259012H92  | <b>\$34<sup>66</sup></b> |
| 3A0034     | Suspended   | Bare leads | CAT: 9X-9484, 151-2457, 9X-6853  | <b>\$34<sup>70</sup></b> |
| 24V Part # | Orientation | Connection | Cross Reference  | Price                    |
| 3A0037     | Pedestal    | Bare leads | CAT: 171-7214, 172-9973, 238-8638, 238-8639, 6V-1108, 6V-1119, 9X-1439, 9X-1443, 9X-1444, 9X-6775, 9X-7165, 9X-7169, 9X-9600; Hyundai: 21N6-20211; John Deere: AT168968; Komatsu: 1259011H92, 1436115H91 | <b>\$32<sup>06</sup></b> |
| 3A0038     | Suspended   | Bare leads | Case: 76036468, 76040180<br>CAT: 9X-4381, 9X-6774, 9X-6874, 133-3037, 2T-3739, 176-0780; John Deere: AT209902  | <b>\$32<sup>06</sup></b> |



**SHD BLUE LED SPOT FORKLIFT SAFETY LIGHT**

The ABL 500 LED series work lights are designed to exceed everyday demands in all applications. This specific Blue version of our LED worklight range ensures a visible sharp edged warning signal on the floor for an increased safety environment.

- Lifetime: 20,000 hours
- Light pattern: sharp-edged spot
- Consumption: 5W
- Voltage: Multi 12-100V; Intensity: 0.2 Amp @ 24V
- Vibration resistance: 10 Grms, from 24Hz to 2000Hz
- 4.29" tall x 4.29" wide x 4.84" deep



| Part #   | Light Pattern    | Bulb     | Price                     |
|----------|------------------|----------|---------------------------|
| SP3A0008 | Sharp Edged Spot | LED blue | <b>\$149<sup>95</sup></b> |

**SL 1000 LED COMPACT WORK LIGHTS**

Through this Service light version, ABL provides an attractive LED product for close range lighting needs. ABL 850 LED SL offers a low consumption (14 watts) solution where high reliability and cost efficiency are required.

- Pedestal mounting
- Connection: DT 2 pin
- 6000 K Color temperature
- Extremely long life (30,000 hours)
- Protected against reverse voltage
- Voltage: 12/24V; 14W consumption
- High vibration resistance
- Dimensions: 3.8"H x 4"W x 2.5"D.



| Part # | Light Pattern | Bulb       | Qty | Price                    |
|--------|---------------|------------|-----|--------------------------|
| 3A0067 | Flood         | 1000 Lumen | 1   | <b>\$99<sup>95</sup></b> |
| 3A0068 | Long Range    | 1000 Lumen | 1   | <b>\$99<sup>95</sup></b> |

**RL 1500 LED WORK LIGHT**

The ABL RL 1500 LED series work lights are designed to exceed everyday demands in all applications. Through stringent engineering and testing practices, we ensure the highest efficiency and durability in even the harshest operating conditions.

- Pedestal mounting
- Connection: DT 2 pin
- 6000 K Color temperature
- Extremely long life (30,000 hours)
- Voltage: 12-24V; 20W consumption
- High vibration resistance
- 3.58" round x 3.03" deep



| Part # | Light Pattern | Bulb       | Qty | Price                     |
|--------|---------------|------------|-----|---------------------------|
| 3A0069 | Flood         | 1500 Lumen | 1   | <b>\$139<sup>95</sup></b> |
| 3A0070 | Long Range    | 1500 Lumen | 1   | <b>\$139<sup>95</sup></b> |

**SL 1500 LED COMPACT WORK LIGHTS**

The ABL 1500 LED is a new LED work lamp with halogen performance, meeting the highest quality demands of the vehicle, forest and mining industry.

- Pedestal mounting
- DT 2 pin connector
- Brightness in day light color (6000 K)
- Low power consumption, 20W
- 12/24V
- Maintenance free
- Extremely long life (30,000 hrs)
- High vibration resistance
- Dimensions: 3.8"H x 4"W x 2.5"



| Part # | Light Pattern | Lumens Output | Price                     |
|--------|---------------|---------------|---------------------------|
| 3A0063 | Flood         | 1500 Lumen    | <b>\$139<sup>95</sup></b> |
| 3A0064 | Spot          | 1500 Lumen    | <b>\$139<sup>95</sup></b> |

**MANY OPTIONS AVAILABLE FOR HIGH-QUALITY LIGHTS ON OUR WEBSITE!**

**ENCLOSED IS A SMALL SAMPLING OF WHAT WE OFFER ...**

ORDER ONLINE AT [WWW.SERVICESTRUCKS.COM](http://WWW.SERVICESTRUCKS.COM)

PRICES SUBJECT TO CHANGE.

# Rugged. Durable. Economical.

For maintenance & finishing, crown work, slope work, or paving! Slope Meters are typically mounted on the dash in the operator's view and will give fast, accurate readings for any slope. The Slope Meter enables the operator to construct true slopes without waves.



**SLOPE  
METER, INC.**



### SLOPE METER NO. 1

Used for all slope and crown construction. The figures shown on the scale represent slope. For example, when the indicator ball is over number "8", it indicates an "8-to-1" slope. The small triangles (shown between 0 and 8) represent degrees, for reference purposes. Slope-Meter "No. 1" is widely used on motor graders, bulldozers, and similar equipment.

PART# 5S0002  
**\$199<sup>99</sup>**



### SLOPE METER NO. 2

Used to determine "percent of grade" and is calibrated to read from .00 to .12 (0-12%). The "No. 2" aids the operator and speeds work on motor graders, asphalt pavers, wheel ditches, tunneling machines, and other equipment where exacting specifications are required.

PART# 5S0003  
**\$199<sup>99</sup>**



### STEEP SLOPE METER

Calibrated in percentage of grade from 0 to 50%. A major use for this meter is in all areas where a steeper slope reading is needed. This product works well on bulldozers and similar equipment.

PART# 5S0004  
**\$199<sup>99</sup>**

### BULK CAB FOAM

Bulk cab foam with perforations, 64 holes per square inch.

- 1" Thick
- 54" Wide
- Sold by the yard (36')

| Part # | Description   | Price                    |
|--------|---------------|--------------------------|
| 8K0004 | Black         | <b>\$79<sup>50</sup></b> |
| 8K0005 | Sailcloth Tan | <b>\$79<sup>50</sup></b> |



### BULK FLOOR MAT

High-quality floor mat made of super-durable, compressed foam rubber material.

- 3/8" Thick
- 60" wide
- Sold by the yard (36')
- Black

PART# 8K0002  
**\$57<sup>99</sup>**



### OFF-ROAD EQUIPMENT MASTER COMPLETE MULTI-SET KEYS

**SALE**

Contains 66\* of the most popular keys for off-highway machines. Keys for these and more makes: ASV, Bobcat, Case, Caterpillar, Daewoo, Doosan, Ford, Gehl, Hitachi, Honda, Hyster, Hyundai, JCB, John Deere, Komatsu, Massey, and more!

PART# 9D0157  
~~\$190<sup>00</sup>~~  
**\$167<sup>99</sup>**

\*number may vary slightly as keys are constantly revised/added per customer demands



### 3830 SNOW PLOW LIGHT SET

SAE/ECE approved for on-road and off-road vehicles. The clear glass lens and free-form reflector provide ideal road illumination in an innovative but rugged and durable design. Along with a pedestal mounting configuration, this light incorporates a moisture-eliminating breather, parking light, and a side repeater. Includes two lights, left and right side.



- Aluminized thermal grade plastic housing
- Horizontal orientation, pedestal mounting
- Integrated 6-pin DT connection
- Bulbs in H4 12v 60/55w

PART# 3A0065  
**\$249<sup>95</sup>**

### COMPACT BACK-UP ALARM

102 dB. For Medium/High Noise areas. Mounts on 3" to 3.35" centers. Compact size and universal mounting bracket maximized location options. Self grounding with stud terminal connections. Sealed in epoxy for protection against dust, moisture and vibration. OEM Crossover: CAT 1612539, JD KV18230, Preco 250, Ecco 530.



PART# 5T0057  
**\$35<sup>51</sup>**

ServiceMate

### SELF-ADJUSTING BACK-UP ALARM

97-112 dB. For Medium/High Noise areas. Mounts on 6" centers. Manually adjusts to 5 decibels above the ambient noise, up to 112 dB. 12/24 VDC. OEM Crossover: CAT 3T1815, JD AT78534, Komatsu 736131C, etc. 24 month warranty.



PART# 5T0052  
**\$169<sup>04</sup>**

ServiceMate

### CONSTRUCTION MULTI-SET KEYS

Contains 21 of the most popular keys for construction machines. Keys for: Bobcat, Bomag, Case, Caterpillar, Doosan F900, Ford, Hitachi, Hyundai, I/R, John Deere, Kawasaki, Komatsu, Kubota, Link Belt, New Holland, "Snoopy Key", Takeuchi, and Volvo. Includes a carabiner clip!

PART# 9D0155  
**\$64<sup>49</sup>**



**WE STOCK INDIVIDUAL OEM KEYS FOR OVER 40 MAKES OF HEAVY EQUIPMENT!**

**TAKE \$10 OFF \$100!\***

USE CODE  
**TOUGHJOBS**  
AT CHECKOUT.

\*Discount can only be used once per order. Valid on orders over \$100. Can not be applied to past orders. Some exclusions apply.



## TOPSPIN™ FULL-VIEW PRE-CLEANER

Helps extend filter life on agricultural and construction equipment!

- Mount on top of the engine intake stack; includes mounting clamp
- Centrifugal force in bowl separates up to 75% of incoming dust before it enters the engine air intake system
- Durable, lightweight, noncorrosive
- Low maintenance
- Full-view plastic bowl lets operator easily see when service is needed
- One-bolt cover retention for service; remove top nut and plastic body then empty—no tools required



| Part #  | Max Airflow | Dimensions |        |       |       |        | Qty | Price               |
|---------|-------------|------------|--------|-------|-------|--------|-----|---------------------|
|         |             | A          | B      | C     | D     | E      |     |                     |
| 6F0087  | 80 CFM      | 1.75"      | 5.59"  | 4.75" | 1.72" | 5.5"   | 1   | \$61 <sup>41</sup>  |
| 6F0088  | 90 CFM      | 2"         | 5.59"  | 4.75" | 1.72" | 5.5"   | 1   | \$61 <sup>47</sup>  |
| 6F0089* | 110 CFM     | 2"         | 7.34"  | 6.19" | 1.72" | 7.25"  | 1   | \$61 <sup>21</sup>  |
| 6F0090  | 130 CFM     | 2.25"      | 7.34"  | 6.19" | 1.72" | 7.25"  | 1   | \$61 <sup>50</sup>  |
| 6F0091  | 150 CFM     | 2.5"       | 7.34"  | 6.19" | 1.72" | 7.25"  | 1   | \$59 <sup>19</sup>  |
| 6F0092  | 170 CFM     | 3"         | 7.34"  | 6.19" | 1.72" | 7.25"  | 1   | \$56 <sup>65</sup>  |
| 6F0093* | 320 CFM     | 3"         | 10.63" | 7.66" | 1.84" | 10.5"  | 1   | \$106 <sup>08</sup> |
| 6F0094  | 330 CFM     | 3.75"      | 10.63" | 7.66" | 1.84" | 10.5"  | 1   | \$106 <sup>16</sup> |
| 6F0095  | 340 CFM     | 4"         | 10.63" | 7.66" | 1.84" | 10.5"  | 1   | \$106 <sup>16</sup> |
| 6F0096* | 660 CFM     | 4"         | 12.06" | 8.19" | 2"    | 11.94" | 1   | \$161 <sup>54</sup> |
| 6F0097  | 340 CFM     | 4.5"       | 10.63" | 7.66" | 1.84" | 10.5"  | 1   | \$105 <sup>76</sup> |
| 6F0098* | 700 CFM     | 4.5"       | 12.06" | 8.19" | 2"    | 11.94" | 1   | \$161 <sup>18</sup> |
| 6F0099  | 740 CFM     | 5"         | 12.06" | 7.69" | 2"    | 11.94" | 1   | \$169 <sup>15</sup> |
| 6F0100  | 1300 CFM    | 6"         | 16.25" | 10"   | 2.81" | 15.94" | 1   | \$435 <sup>88</sup> |
| 6F0101  | 1500 CFM    | 7"         | 16.25" | 10"   | 2.81" | 15.94" | 1   | \$479 <sup>83</sup> |

\* Heavy Duty Option

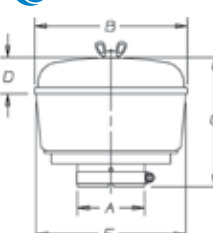

## CORDLESS, MOBILE, PROPANE COOLANT HEATER

The Hilton cordless engine heater has been designed to preheat all liquid-cooled engines that require preheating to start in cold weather. The Hilton heater also eliminates the need to idle diesel engines in cold weather. This heat can be used in the cab and bunk areas as well as in the engine.

Electricity from the vehicle activates the heater, allowing it to operate anywhere. The Hilton cordless engine heater is a catalytic burner, providing safe flameless heat. It uses 5.4 oz. of propane per hour, which produces 6,500 BTU. Hilton heaters are available for both 12-volt and 24-volt installation. A 20# cylinder of propane will last approximately 60 hours.

The B Series heater produces more than double the amount of heat of the LP 6500 heater, and is an excellent choice for quick engine starting and for people who want to heat the motor and have extra heat for other applications such as heating the bunk area, fuel or hydraulics.

| Part # | Description                     | Output Per Hour | Volts | Dimensions HxD   | Price               |
|--------|---------------------------------|-----------------|-------|------------------|---------------------|
| 5J0002 | LP 6500 Cordless Engine Heater  | 6500 BTU        | 12    | 12.5 in. x 5 in. | \$799 <sup>95</sup> |
| 5J0003 | LP 6500 Cordless Engine Heater  | 6500 BTU        | 24    | 12.5 in. x 5 in. | \$799 <sup>95</sup> |
| 5J0004 | B Series Cordless Engine Heater | 16,000 BTU      | 12    | 12.5 in. x 5 in. | \$949 <sup>95</sup> |
| 5J0005 | B Series Cordless Engine Heater | 16,000 BTU      | 24    | 12.5 in. x 5 in. | \$949 <sup>95</sup> |

Heater comes with mounting bar, fuel pressure regulator, and a wiring harness that connects to the on/off switch. You will need to furnish the propane tank and hoses (3/4" heater hose and 1/4" flexible fuel line hose).

## ENGINE HEATER TIMER

Programmable timer for Hilton heaters. Set your Hilton heater up to turn on at any time. Seven day, eight event programming. 12 or 24 volt operation. Manual or automatic programmable timer controls.

| Part # | Description                             | Time           | Volts    | Price               |
|--------|---|----------------|----------|---------------------|
| 5J0006 | Hilton Programmable Engine Heater Timer | 7 day, 8 event | 12 or 24 | \$236 <sup>60</sup> |



## AIRHAWK PLUS SEAT CUSHION

Use the Airhawk Plus Seat Cushion as a high quality flotation cushion to keep you riding in comfort while on the job. The Airhawk Seat Cushion uses fully adjustable air-filled individual cells that are controlled by an innovative air valve and pump that will distribute seating weight evenly for a more comfortable ride. Using the dry flotation technology will help reduce grievances to pressure points, which are the main source of numbness and back pain.

- Durable Black Polyvinyl material
- Breathable and stretchable nylon/lycra blend cover
- Isoflow air adjustment valve
- 19" x 19" square cushion
- Dry flotation technology
- Strong wear resistance



PART# 8K0006  
\$166<sup>99</sup>

## THE INFORMER™ AIR FILTER INDICATOR

For graduated, continuous readings

The Informer, when mounted on the air cleaner or the dashboard, provides a continuous reading whether the engine is running or is shut down. Reset button is on top. Kit includes full installation instructions and a safety filter fitting. For remote mounting, order a 6F0067 flange and a 6F0068 90° elbow.

| Part # | Description         | Restriction Limit            | Price              |
|--------|---------------------|------------------------------|--------------------|
| 6F0064 | Gauge and Fitting   | 20" H <sub>2</sub> O/5 kPa   | \$49 <sup>59</sup> |
| 6F0065 | Gauge and Fitting   | 25" H <sub>2</sub> O/6.2 kPa | \$48 <sup>68</sup> |
| 6F0066 | Gauge and Fitting   | 30" H <sub>2</sub> O/7.5 kPa | \$48 <sup>92</sup> |
| 6F0067 | Remote Mount Flange | .                            | \$26 <sup>00</sup> |
| 6F0068 | 90° Elbow           | .                            | \$20 <sup>27</sup> |



## SAFETY DECALS AND WARNING LABELS

We live in an ever changing world of laws and regulations so it's a necessity that we put the right safety decals on our machines; our selection of high-quality details will help you accommodate OSHA. Decals are cut out of solid color vinyls which is guaranteed not to fade from the elements, which means your decals are brighter, stronger, more eye appealing, and generally better for a longer duration of time.



| Part # | Description   | Size            | Qty | Price               |
|--------|---|-----------------|-----|---------------------|
| 7B0017 | Off Road Fuel   | 5" x 7"         | 5   | \$332 <sup>26</sup> |
| 7B0018 | On Road Fuel  | 5" x 7"         | 5   | \$332 <sup>26</sup> |
| 7B0019 | Diesel Fuel Only (Red)                                | 2" x 3"         | 5   | \$15 <sup>00</sup>  |
| 7B0020 | Diesel Fuel Only (Black)                              | 2" x 4"         | 5   | \$15 <sup>00</sup>  |
| 7B0021 | Hyd. Oil  | 2" x 8"         | 5   | \$21 <sup>88</sup>  |
| 7B0022 | Check Oil Daily                                       | 2" x 2"         | 5   | \$12 <sup>00</sup>  |
| 7B0023 | Improper jumper cable connections can cause explosion | 2" x 4"         | 5   | \$13 <sup>13</sup>  |
| 7B0024 | Anti-freeze tested Degrees / Date                     | 3-1/2" x 4-1/2" | 5   | \$21 <sup>88</sup>  |
| 7B0025 | Read owners manual before operating                   | 4" x 5"         | 5   | \$28 <sup>00</sup>  |
| 7B0026 | Service record  | 5" x 2"         | 5   | \$15 <sup>75</sup>  |
| 7B0027 | Hook w/ up arrow                                      | 2" x 3"         | 5   | \$14 <sup>00</sup>  |
| 7B0028 | Operator responsible for greasing/cleaning equipment  | 2" x 4"         | 5   | \$13 <sup>13</sup>  |
| 7B0029 | Operator responsible for checking water/oil daily     | 2" x 4"         | 5   | \$13 <sup>13</sup>  |

MORE STYLES AVAILABLE ONLINE!

## ACME SPECIALTY HEAVY DUTY MIRRORS

Our off-road mirrors are vibration-resistant either at speed or at idle, our tempered mirrors withstand 5 G-force impacts. They can be used in extreme temperature variations and provide a maximum field of view. Mirrors also feature a heavy-gauge steel backing, a minimum of 16 gauge steel.



8" X 16" CONVEX TEMPERED MIRROR  
(16.85" distance between brackets). Crossover #: CAT 5P-6876  
PART# 5T0142  
\$149<sup>64</sup>



6" X 16" CONVEX TEMPERED MIRROR  
(16.85" distance between brackets). Crossover #: Cat 5P-6871  
PART# 5T0147  
\$141<sup>65</sup>

MORE SIZES ONLINE!

# TRUCK AND TRAILER ACCESSORIES

## M-80 WARNING FLAG

Durable 18" x 18" mesh jersey flag sewn onto a vinyl welt with a flexible spreader rod to hold flag out flat. Contains no wire to scratch or cause damage to your load. For use with a magnet mount. 80 lb. minimum pull strength magnet recommended.



| Part # | Color  | Size      | Price                   |
|--------|--------|-----------|-------------------------|
| 5P0020 | Red    | 18" x 18" | <b>\$8<sup>95</sup></b> |
| 5P0021 | Orange | 18" x 18" | <b>\$8<sup>95</sup></b> |

## M-80 MAGNET MOUNT FOR FLAGS

Hold your flag securely where you need it. Large 2-5/8" dia. chrome steel cup magnet mount. Has 80 lb. pull strength. Functional, durable and rust resistant. Includes 1/4" nylock wing nut to hold flag securely.



PART# 5P0034  
**\$10<sup>35</sup>**

## WOOD DOWEL FLAG

Quality red or orange mesh jersey 18" x 18" flag glued and stapled onto a 3/6" wood dowel.



| Part # | Color  | Dowel Size | Pkg | Price                    |
|--------|--------|------------|-----|--------------------------|
| 5P0030 | Red    | 5/8" x 36" | 12  | <b>\$66<sup>84</sup></b> |
| 5P0031 | Orange | 5/8" x 36" | 12  | <b>\$66<sup>84</sup></b> |
| 5P0032 | Red    | 3/4" x 36" | 12  | <b>\$75<sup>24</sup></b> |
| 5P0033 | Orange | 3/4" x 36" | 12  | <b>\$75<sup>24</sup></b> |

## STRAP BANDS

7"x1"x0.065" heavy duty rubber band. Holds straps tight when not in use for easy storage. Pkg of 6.

PART# 5P0002  
**\$7<sup>50</sup>**



## TORQUEDRIVE™ STEEL OFFSET CHAIN BINDERS

The Absolute Highest Quality, Safest, Fastest, Tension Retaining Load Binder IN THE WORLD!!

Faster and safer tie down and release. Tighter chains every time.

- **Ideal for tight areas.** In confined situations, TorqueDrive™ can be 20 to 30 times faster; allowing for total powered rotation, where a manual binder may only be able to get a quarter rotation or less.
- **Powers through** dirty or neglected threads on binders. Simply adjust the torque setting on your portable drill.
- **Built to last.** Manufactured with heat treated, forged components for a long dependable life. Smooth operation due to a precision aligned worm gear assembly with grease fitting, for years of trouble free service.
- **Manufactured to WSTDA-T6 standards. G70 Rated.**
- We recommend an 18 volt cordless drill with at least 200 lbs of torque. You will need a 3/8" adapter and 3/4" socket to operate.

The ultimate for the steel hauler! Truly the best binder on the market bar none. Gets chains tighter, safely and faster than anything on the market. Store your endlinks inside the barrel when storing and they will be out of the road salt / brine and stay lubricated. Heavy / implement grade paint resistant to chipping, zinc coated, sealed gear box. You will love these!

Choose from 3 Models, Blue Line, Red Line, and Green Line.

## QUICKMOUNT WARNING FLAGS

Spring-loaded, quick-release receiver constructed of 303 stainless steel for durability and rust protection. Fast & easy installation. Comes with 18" x 18" durable mesh jersey flag that is replaceable. Flag spins freely on staff for maximum visibility. Requires bracket assembly, sold separately.



| Part # | Description             | Dimensions | Price                    |
|--------|-------------------------|------------|--------------------------|
| 5P0009 | Red Flag Assembly       | 18" x 18"  | <b>\$39<sup>99</sup></b> |
| 5P0010 | Orange Flag Assembly    | 18" x 18"  | <b>\$39<sup>99</sup></b> |
| 5P0011 | Replacement Flag Red    | 18" x 18"  | <b>\$7<sup>65</sup></b>  |
| 5P0012 | Replacement Flag Orange | 18" x 18"  | <b>\$7<sup>65</sup></b>  |

## QUICKMOUNT MOUNTING BRACKET

Our heavy duty stainless steel mounting bracket for quickmount flag assembly. Comes with stainless steel hardware. Mounts flag at either a 45° or 90° angle. Stud kit included. The best mount available for the job.



PART# 5P0016  
**\$21<sup>99</sup>**

## TURBO SAVER

Don't destroy your turbo while hauling your equipment.

Wind can cause your turbo to spin. Due to lack of lubrication the bearings can be ruined. With Turbo Saver, the wind cannot turn the turbo. This cuts down on expensive repairs and downtime. Turbo Saver is reusable and eliminates the need to use duct tape or rags in the exhaust pipe.



| Part # | Description    | Price                    |
|--------|----------------|--------------------------|
| 5T0260 | 7" Original    | <b>\$39<sup>99</sup></b> |
| 5T0261 | 12" Industrial | <b>\$44<sup>99</sup></b> |

## GROMMET WARNING FLAGS

Durable mesh jersey flag 18" x 18" with #2 brass grommets for universal attachment. Reliable and a long service life for minimal cost.



| Part # | Color  | Size      | Pkg | Price                    |
|--------|--------|-----------|-----|--------------------------|
| 5P0024 | Red    | 18" x 18" | 12  | <b>\$44<sup>16</sup></b> |
| 5P0025 | Orange | 18" x 18" | 12  | <b>\$44<sup>16</sup></b> |

## EZ-HOOK WARNING FLAG

Durable red or orange mesh jersey sewn into a flexible vinyl welt with a heavy bungee. Resists ripping and fading. Makes flagging your load fast and easy. This is the premiere flag on the market and is extremely versatile. Available in 2 sizes and colors.



| Part # | Color  | Size   | Price                    |
|--------|--------|--------|--------------------------|
| 5P0022 | Red    | 18x18" | <b>\$9<sup>00</sup></b>  |
| 5P0023 | Orange | 18x18" | <b>\$9<sup>00</sup></b>  |
| 5P0037 | Red    | 24x24" | <b>\$11<sup>25</sup></b> |
| 5P0038 | Orange | 24x24" | <b>\$11<sup>25</sup></b> |

## OVERSIZE LOAD SIGNS



Bold 12" black letters hand silk screened on yellow background. Easy to clean warning signs are available in two styles:

- **Grommet Style:** Six #2 brass grommets for easy attachment.
- **EZ Hook Style:** Durable vinyl coated poly-mesh material allows airflow. Sewn into a strong flexible welt with heavy 18" bungee on each end. Wrap around double stitch border. Easy to attach.

| Part #               | Description          | Dimensions | Price                    |
|----------------------|----------------------|------------|--------------------------|
| <b>GROMMET STYLE</b> |                      |            |                          |
| 5P0003               | Oversize Load        | 18" x 84"  | <b>\$27<sup>95</sup></b> |
| 5P0005               | Long Load            | 18" x 84"  | <b>\$27<sup>95</sup></b> |
| 5P0035               | Wide Load            | 18" x 84"  | <b>\$27<sup>95</sup></b> |
| 5P0007               | Oversize Load Escort | 14" x 60"  | <b>\$26<sup>95</sup></b> |

| Part #               | Description          | Dimensions | Price                    |
|----------------------|----------------------|------------|--------------------------|
| <b>EZ HOOK STYLE</b> |                      |            |                          |
| 5P0004               | Oversize Load        | 18" x 84"  | <b>\$31<sup>95</sup></b> |
| 5P0006               | Long Load            | 18" x 84"  | <b>\$31<sup>95</sup></b> |
| 5P0036               | Wide Load            | 18" x 84"  | <b>\$31<sup>95</sup></b> |
| 5P0008               | Oversize Load Escort | 14" x 60"  | <b>\$29<sup>95</sup></b> |

## BATTERY POWERED LED PERSONAL SAFETY LIGHTS

360° LED beacon in amber operates for 300-400 hours on 2 D batteries (not included). Features 24 ultra bright LED's and 60 triple FPM.

- Photocell control for night time use
- Includes magnet mount base and carrying strap
- Size 4-1/8 D X 4-3/4" H
- Optional "L" bracket for logging or pole applications available
- 90 day warranty

| Part # | Description  | Qty | Price                    |
|--------|--------------|-----|--------------------------|
| 5T0262 | Strobe Light | 1   | <b>\$74<sup>44</sup></b> |
| 5T0263 | Bracket      | 1   | <b>\$27<sup>58</sup></b> |



# Protect Your Fleet.

Let us solve your under-inflation and flat tire problems. Multi Seal® – superior science, superior sealants.



## MULTI SEAL® PRO HD 2500™ TIRE SEALANT

Your heavy tires routinely endure heavy punishment. They encounter 'tire killers' such as jagged rocks, broken concrete, rebar, scrap metal, welding rods, nails and other hazardous objects. MULTI SEAL® PRO HD 2500™ Formula allows your tires to withstand the rigors of heavy, continuous use. Your tires, drivers and equipment are protected from job-stopping flats due to slow leaks around the rim as well as air loss through punctures – from pinholes to serious punctures (up to 3/4" dia. in the tread area). One treatment of PRO HD 2500™ Formula will reduce flats by up to 95%, keeping you rolling safely, thereby saving you money and lost hours. Easily installed, PRO HD 2500™ Formula lasts the life of the tire and is easily washed out at the end of the tire's life.

| Part # | Sizes                                   | Price               |
|--------|---|---------------------|
| 6N0003 | (4) 1 Gallon Bottles                    | \$266 <sup>00</sup> |
| 6N0006 | 1 oz. Pump Pack for 1 Gal. Bottle       | \$11 <sup>50</sup>  |
| 6N0004 | 5 Gallon Bucket                         | \$329 <sup>00</sup> |
| 6N0005 | Extra Heavy Duty Pump for 5 Gal. Bucket | \$120 <sup>00</sup> |

**Use for heavy equipment:** Backhoes, Articulated Loaders, Road Graders, Ag Equipment—Tractors, Mowing machines, Harvesters, Haul trailers, Skid Loaders, Cranes, Trucks, and more!



## MULTI SEAL® FLATOUT TIRE SEALANT

FlatOut™ is a one-time tire sealant that prevents flats due to punctures up to 1/2" and stops slow leaks around the bead or valve stem or due the natural porosity of the tire. It is made of synthetic TangleTek™ fibers including KEVLAR™ and unique DamRight™ fillers suspended in our special Never-Settle™ base fluid (non-adhesive, non-toxic and freeze-resistant). When a puncture occurs, escaping air forces FlatOut™ into the wound creating an airtight fiber jam. Think beaver dam but with the fibers and fillers forming an amazingly durable plug! And, it's proven, having been used in Military and industrial applications for decades! **Install now for 24/7 protection: Seals puncture after puncture for 10+ years!**

### QUICKSTRIKE™ ON-ROAD

Great for Travel Trailers, Boat Trailers, Horse Trailers, Toy Haulers, Cargo Trailers, Utility Trailers and more. (8) 32 oz. bottles.

PART# 6N0007  
**\$150<sup>00</sup>**

### QUICKSTRIKE™ OFF-ROAD

Great for Lawn Mowers, UTVs, ATVs, Fat Tire Bikes, Dirt Bikes, Small Tractors, Wheelbarrows, Wood Chippers, Snow Blowers and more. (8) 32 oz. bottles.

PART# 6N0008  
**\$150<sup>00</sup>**

### SPORTSMAN

Great for ATVs, UTVs / Side-by-Sides, Golf Carts, Dirt Bikes, Off-Road-Only Jeeps and more. (8) 32 oz. bags.

PART# 6N0009  
**\$180<sup>00</sup>**



## FLARETITE STANDARD CARBON STEEL SEALS SAMPLE KIT

This permanent, "Leak-Free" connection exceeds the performance of today's ORFS fittings, and at significantly lower cost. It is a metal stamping, designed with multiple, concentric sealing rings and coated with a dry-to-the-touch, baked-on Loctite™ sealant. When inserted into a fitting, the concentric rings form multiple seals down the face of the flare, while the Loctite™ coating fills minor imperfections, dramatically increasing the integrity of the fitting.

- 304 Stainless steel seal with Loctite Vibra Seal coating.
- Rated for -40° to 300°F temps and all common gases & fluids.
- 61 seals, 1/4" thru 2", fits JIC 37° fittings

PART# 1H0002  
**\$299<sup>96</sup>**



## 293 PC. BACK-UP RING KIT

This 293 piece kit contains 36 of the most popular size "Parback®" Style Dished Cross Section back-up rings. Molded of 90A Durometer Buna-N rubber, they stretch for installation and return quickly to their original size. SIZES CORRESPOND TO O-RING NUMBERS. Your shop and service truck should not be without this handy kit.

36 sizes, 293 O-rings

PART# 4J0007  
**\$129<sup>72</sup>**



## DAKOTA SHINE KITS

Dakota Shine is a unique and patented product that will restore the color, lustre and value to faded and oxidized surfaces like paint, decals, plastics and more. Dakota Shine is a ready-to-use product that requires no mixing.

**Each kit includes:** Dakota Prep, Dakota Shine Aerosol, Dakota Shine Scrub Pads and Instructions. Industrial kits also include Dakota Shine in 1 Gallon containers.



| Part # | Description           | Coverage | Price               |
|--------|-----------------------|----------|---------------------|
| 4D0001 | Pro Kit (Case of 2)   | 100 SF   | \$199 <sup>95</sup> |
| 4D0002 | Small Industrial Kit  | 400 SF   | \$327 <sup>95</sup> |
| 4D0003 | Medium Industrial Kit | 800 SF   | \$549 <sup>95</sup> |

\*A medium sized pickup or tractor is approx. 100 sq. ft.

## BRITEPLUS MX

BritePlus MX is the choice for superior cleaning of raw or brushed surfaces. Clean stained and oxidized aluminum.\*

BritePlus MX cuts through yellow stains, black streaks, haze and other discolorations. It cleans and brightens faded and oxidized aluminum. It even works great on painted surfaces.

BritePlus is a proven cleaner for your toughest jobs, like over-the-road trailers, SUV wheels, engine compartments, and more. A 2.5 gallon container is normally enough product to clean a 20 ft. trailer twice.

| Part # | Description           | Price               |
|--------|-----------------------|---------------------|
| 4D0006 | BritePlus 2.5 Gallons | \$65 <sup>95</sup>  |
| 4D0007 | BritePlus 5 Gallons   | \$103 <sup>95</sup> |

\*Can dull and/or whiten polished surfaces, use AlumiWash for those applications



## ALUMIWASH RTU

Choose AlumiWash RTU (Silver BritePlus MX) on polished surfaces. Maintain new or polished aluminum and stainless steel.

AlumiWash is a proven cleaner for very reflective, high-shine, and polished metal surfaces - like newer cattle trailers, tankers, polished wheels, and tanks. Our most gentle formulation - will not harm polished surfaces.

Apply with a standard weed sprayer or a bucket and soft-bristled brush. No mixing required!

| Part # | Description                 | Price               |
|--------|-----------------------------|---------------------|
| 4D0004 | Silver BritePlus 2.5 Gallon | \$65 <sup>95</sup>  |
| 4D0005 | Silver BritePlus 5 Gallons  | \$103 <sup>95</sup> |



## THREAD CHECKER

Each size has a bolt and nut thread checker on the same gauge. Thread sizes are permanently stamped onto each gauge. Unit comes with a wire cable with loop on each end for convenient hanging. The individual gauges rotate freely on the wire cable for fast verification. Hardened steel.

**INCH SIZE**  
SAE 1/4" - 1-1/2"  
Clear zinc plated

PART# 2T0002  
**\$43<sup>00</sup>**

**METRIC SIZE**  
Metric 3-24  
Black oxide finish

PART# 2T0003  
**\$43<sup>00</sup>**

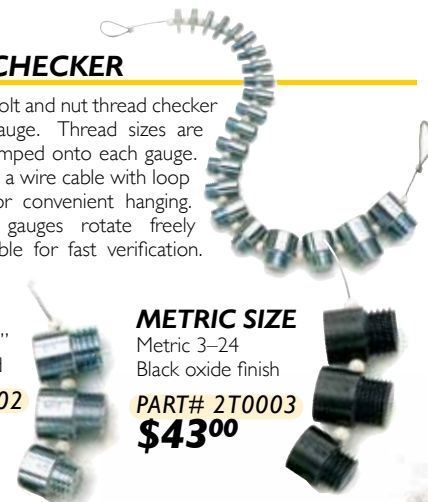

# Downtime Costs Money.

For as long as heavy equipment has been a crucial part of job success - equipment has broken down on a job because of a bad o-ring. Delays cost tens of thousands of dollars in lost time because of a part that costs a few dollars. We sell high-quality OEM o-ring kits that will ship within 24 hours, preventing your low-cost part failures from becoming big-dollar delays!



## CATERPILLAR® MEGA O-RING KIT

This double-sided mega kit contains Caterpillar kits: 4C-4788, 4C-4784, 4C-5859, 4C-8253, 9S-3135 and 4C-4782.

### Contents of Kit:

- 8 sizes Orfs o-rings
  - 11 sizes SAE flange o-rings
  - 13 sizes standard Boss o-rings
  - 10 sizes metric port o-rings
  - 9 sizes d-rings for XT5&6 flange connections
  - 32 sizes yellow silicone o-rings
- 83 Sizes, 633 O-rings, 45 D-rings**

PART# 9Q0005  
**\$517<sup>50</sup>**



## CATERPILLAR® FLAT FACE KIT

This compact single-sided kit contains high-pressure, Ors (flat face) o-rings for Caterpillar equipment, which replaces Caterpillar kit #4C-5859.

### Contents of Kit:

- 8 sizes Ors (flat face) o-ring
- 8 Sizes, 265 O-rings**

PART# 9Q0007  
**\$49<sup>20</sup>**



## CATERPILLAR® D-RING KIT

This single-sided, high-pressure kit contains D-rings for Caterpillar XT 5 and 6 flange connections, which replaces Caterpillar kit #4C-4784.

### Contents of Kit:

- 9 sizes D-rings
- 9 Sizes, 80 D-rings**

PART# 9Q0009  
**\$162<sup>75</sup>**



## BOBCAT® O-RING KIT

This single-sided kit contains low- and high-pressure o-rings for Bobcat equipment, including a large assortment for hose end fittings.

### Contents of Kit:

- 8 sizes / 96 brown Viton o-rings
  - 14 sizes low- and high-pressure o-rings
- 22 Sizes, 250 O-rings**

PART# 9Q0002  
**\$168<sup>00</sup>**



## KOMATSU MEGA O-RING KIT

This two-sided, all high-pressure mega kit covers a wide range of part numbers for Komatsu equipment. Also included is a full o-ring assortment for Parker Hose fittings.

### Contents of Kit:

- 10 sizes 21T Green Excavator Series o-rings
  - 26 sizes 07000-1 Series o-rings
  - 5 sizes 07002-1 Series o-rings
  - 25 sizes Boss, flange, flat face o-rings for Parker Hose fittings
- 66 Sizes, 567 O-rings**

PART# 9Q0028  
**\$440<sup>00</sup>**



## KOMATSU SUPER O-RING KIT

This double-sided super o-ring service kit is a replacement for Komatsu kits: 1400686H91, 1400688H91, 1400689H91, 1400690H91, 1400692H91 and 1400693H91.

### Contents of Kit:

- 19 sizes 07000-1 series o-rings
  - 5 sizes 02896 series o-rings
  - 8 sizes 07002 series o-rings
  - 22 sizes 07000-7 series o-rings
  - 20 sizes 07000-E series o-rings
  - 20 sizes 07000-F series o-rings
  - 10 sizes 21T series o-rings
- 104 Sizes, 1002 O-rings**

PART# 9Q0027  
**\$658<sup>00</sup>**



## HITACHI MEGA O-RING KIT

This two-sided mega kit contains low- and high-pressure o-rings for EX100 through EX3500 Hitachi Excavators. (Replaces Hitachi small, medium and large o-ring kits, along with a variety of other commonly used o-rings.)

### Contents of Kit:

- 46 sizes low- and high-pressure o-rings
  - Large assortment of Viton o-rings for high-temp. use
- 46 Sizes, 332 O-rings**

PART# 9Q0003  
**\$449<sup>50</sup>**



Notice. All manufacturers names, numbers, symbols and descriptions on the Q-Pac O-Ring Kits are used for reference purposes only, and it is not implied that any part listed is the product of the original equipment manufacturer.

## JOHN DEERE® INDUSTRIAL O-RING KIT

This double-sided, industrial o-ring kit contains a large assortment of high- and low-pressure o-rings for John Deere equipment, which replaces John Deere kit #AT130208, and also includes John Deere kit #AT85197 and #TY16429.

### Contents of Kit:

- 8 sizes Ors (flat face) o-rings
  - 13 sizes standard Boss o-rings
  - 59 sizes various high and low-pressure o-rings
- 80 Sizes, 713 O-rings**

PART# 9Q0015  
**\$465<sup>00</sup>**



## JOHN DEERE® MASTER HOSE END O-RING KIT

This two-sided, all high-pressure master hose end kit contains John Deere kits #AT85197, #AT196833, #TY16430, #TY16429 and #TY16431.

### Contents of Kit:

- 8 sizes Ors (flat face) o-rings
  - 10 sizes SAE split-flange o-rings
  - 13 sizes standard Boss o-rings
  - 9 sizes metric port o-rings
  - 12 sizes 24° cone o-rings
- 52 Sizes, 545 O-rings**

PART# 9Q0016  
**\$320<sup>00</sup>**



## JOHN DEERE® HOSE END O-RING KIT

This single sided, industrial hose end kit contains high-pressure o-rings for use on John Deere equipment and replaces John Deere kits #AT85197, #TY16429 and #TY16430.

### Contents of Kit:

- 8 sizes Ors (flat face) o-rings
  - 10 sizes SAE Flange o-rings
  - 13 sizes Boss o-rings
- 31 Sizes, 427 O-rings**

PART# 9Q0017  
**\$198<sup>00</sup>**



## JOHN DEERE® FLAT FACE O-RING KIT

This compact single-sided kit contains all high-pressure, Ors (flat face) o-rings for John Deere equipment, which replaces John Deere kit #AT85197.

### Contents of Kit:

- 8 sizes Ors (flat face) o-rings
- 8 Sizes, 265 O-rings**

PART# 9Q0026  
**\$49<sup>20</sup>**



## VOLVO INDUSTRIAL O-RING KIT

This two-sided mega kit contains Volvo kits #15155158, 11708294, #63049, #14511214 and other high-usage standard and metric o-rings.

### Contents of Kit:

- 7 sizes Ors (flat face) o-rings
  - 10 sizes 37° o-rings
  - 9 sizes Boss o-rings
  - 6 sizes flange o-rings
  - 34 sizes standard & metric o-rings
- 75 Part #'s, 864 O-rings**

PART# 9Q0048  
**\$426<sup>25</sup>**



**OVER 40 KITS AVAILABLE ONLINE!**

# SHOP EQUIPMENT AND SERVICE TOOLING

## AIR COMB™

Innovative Air Comb™ blows air at a 90° angle. Patent-pending air guns have a multi-port nozzle with five holes on the top of the wand that maximize pressure and volume at a 90° angle. Provides a focused, high-pressure output that cleans hard-to-reach areas. Fit inside oval and cylindrical air filters, radiators or AC condensers. Choose from 12", 24", 36", or 48" lengths. Imported.

| Part # | Description   | Price                    |
|--------|---------------|--------------------------|
| 7N0514 | 12" Air Comb™ | <b>\$38<sup>99</sup></b> |
| 7N0515 | 24" Air Comb™ | <b>\$43<sup>99</sup></b> |
| 7N0516 | 36" Air Comb™ | <b>\$50<sup>99</sup></b> |
| 7N0517 | 48" Air Comb™ | <b>\$56<sup>99</sup></b> |

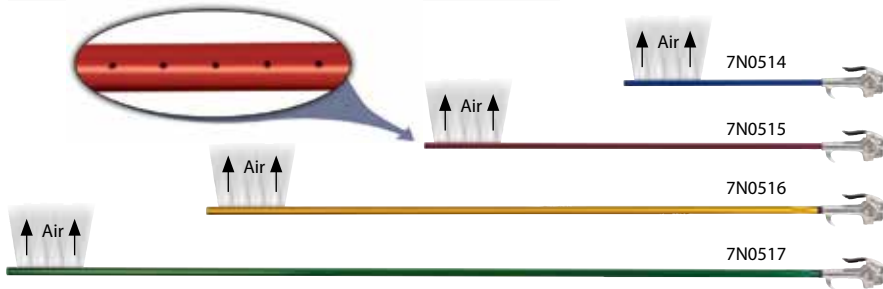

## AIR FILTER BLASTER MAX

Air Filter Blaster is a new patented method for air filter cleaning that dramatically reduces air filter replacement and fuel usage on motorized equipment.

The system requires no expensive add-ons or external devices – it requires only a simple source of compressed air. Ports within the Air Filter Blaster's centrifugal forced air induction chamber create a shaft rotation that uniformly vibrates and discards dirt and particles from the inside of the air filter outwards.

The portable unit is designed to be taken directly into the field or on the road with a service truck or for dedicated use on a single piece of movable equipment. Cleans filters up to 25" tall. Requires a compressor with 90 psi capabilities.

### Includes:

- One 6" rotor head to fit the most common filters
- Filter Blaster Induction chamber
- Protective hard case

PART# 8A0002  
**\$299<sup>00</sup>**



### ADDITIONAL ROTOR HEADS

| Part #  | Description   | Price                    |
|---------|---|--------------------------|
| 8A0004  | 3" Rotor Head - For filters w/ inside dia. 3-4-1/2"     | <b>\$59<sup>00</sup></b> |
| 8A0005  | 4-1/2" Rotor Head - For filters w/ inside dia. 4-1/2-6" | <b>\$59<sup>00</sup></b> |
| 8A0006* | 6" Rotor Head - For filters w/ inside dia. 6-9"         | <b>\$59<sup>00</sup></b> |
| 8A0007  | 9" Rotor Head - For filters w/ inside dia. 9" +         | <b>\$59<sup>00</sup></b> |

\*Comes standard with Portable units

## LEACHROD BLADE LIFT TOOL

The Blade Lift Tool was designed to effortlessly and safely change the blades on dozers, road graders, snow plows, v plows and swing arms.

The Leachrod Tool makes it quick and easy for a single person to safely change the wear edges on maintenance vehicles. Simply insert the Leachrod pins through the blade. Lift and align pins on machine and slide into position.

### Reasons You Need The Leachrod

- Helps eliminate risky lifting techniques on cumbersome edges.
- Gives you control over heavy blade equipment without straining your back - reduces back injuries.
- Makes your workload more efficient, reducing the time it takes to perform a motor grader or snow plow blade exchange - saving time and money.

Snow Plow, Dozer, Grader - Comes w/ quick pin release to enable handle to bend at a 60° angle; allows for addn'l clearance.

PART# 1P0012  
**\$2,050<sup>00</sup>**



## SLIDE SLEDGE® HAMMER TOOLS

The powerful Slide Sledge® Heavy Equipment™ Hammer reduces dangerous, time-consuming hammer and chisel jobs to a one-man, one-tool operation. The linear motion of Slide Sledge® focuses power for precision impact to drive pins and make other tough maintenance jobs easier, faster and a whole lot safer.

- Safer and more accurate
- Reduces downtime
- Increases productivity
- Extremely powerful
- Versatile

8P0003



### HEAVY EQUIPMENT™

Ideal for most standard applications. Compact 30" is great for fitting into tight areas.

| Part # | Description          | Weight | Price                     |
|--------|----------------------|--------|---------------------------|
| 8P0002 | 30" Heavy Equipment™ | 9 lbs  | <b>\$559<sup>50</sup></b> |
| 8P0003 | 46" Heavy Equipment™ | 13 lbs | <b>\$630<sup>00</sup></b> |

### HEAVY EQUIPMENT™ BMF

Larger diameter BMF series delivers Biggest Maximum Force for your toughest applications.

| Part # | Description              | Weight | Price                     |
|--------|--------------------------|--------|---------------------------|
| 8P0004 | 30" Heavy Equipment™ BMF | 14 lbs | <b>\$665<sup>00</sup></b> |
| 8P0005 | 46" Heavy Equipment™ BMF | 21 lbs | <b>\$791<sup>00</sup></b> |



8P0004

## SLIDE SLEDGE® TIPS AND ACCESSORIES AVAILABLE ON OUR WEBSITE!

## DUMP-LOK®

Prevent Injuries and Fatalities from Unsecured Dump Beds. DUMP-LOK is a unique and simple solution that safely secures the dump bed, preventing injuries. DUMP-LOK holds dump beds at angles higher than most dump truck manufacturer body props, giving workers safe access to more areas underneath the dump bed. Sold as a pair.

Wide Top Part #'s below, also available with Flat Top and Notched Style. Call to order.

| Part # | Description / Max Weight                      | Price                       |
|--------|---|-----------------------------|
| 9U0007 | UDL-105 for 4.75" Max Truck Frame, 50,000 lbs | <b>\$1,250<sup>00</sup></b> |
| 9U0009 | UDL-106 for 6" Max Truck Frame, 50,000 lbs    | <b>\$1,250<sup>00</sup></b> |
| 9U0014 | UDL-1075 for 7" Max Truck Frame, 50,000 lbs   | <b>\$1,250<sup>00</sup></b> |
| 9U0016 | UDL-108 Unlimited Truck Frame, 75,000 lbs     | <b>\$3,400<sup>00</sup></b> |



# JOB SITE TOOLS AND EQUIPMENT

## HASTINGS NON-CONDUCTIVE FIBERGLASS TELESCOPING MEASURING RODS

Designed for quick, one-man measurements of vertical or horizontal distances up to 50'. Extends for measurement, retracts to 69" for storage. Measurements are read directly, no calculations are necessary. Non-conductive. Made of tough, durable fiberglass. Available in English or Metric. Features a Voltage Rating of 100,000 volts per foot per 5 minutes. Excellent for measuring heights of trees, power lines, ceilings, and dimensions of woodpiles. Can also be used to measure horizontal surfaces, such as width of streams or distance between tree seedlings.

### ENGLISH RODS

Graduated in feet, inches, and half-inches. All figures and graduations in black. Background color is yellow.

| Part # | Description                 | Price               |
|--------|-----------------------------|---------------------|
| 3H0089 | 25' Extended, 69" Retracted | \$400 <sup>19</sup> |
| 3H0090 | 30' Extended, 69" Retracted | \$503 <sup>19</sup> |
| 3H0091 | 35' Extended, 69" Retracted | \$609 <sup>38</sup> |
| 3H0092 | 40' Extended, 69" Retracted | \$759 <sup>55</sup> |
| 3H0093 | 50' Extended, 69" Retracted | \$970 <sup>44</sup> |

### METRIC RODS

Graduated in meters, decimeters, and centimeters. Meter figures in red. All other figures and graduations are black. Background color is yellow.

| Part # | Description                     | Price               |
|--------|---------------------------------|---------------------|
| 3H0094 | 7.5m Extended, 1.75m Retracted  | \$400 <sup>18</sup> |
| 3H0095 | 10.5m Extended, 1.75m Retracted | \$609 <sup>38</sup> |
| 3H0096 | 12m Extended, 1.75m Retracted   | \$908 <sup>00</sup> |
| 3H0097 | 15m Extended, 1.75m Retracted   | \$931 <sup>09</sup> |



### CARRYING CASE

Water-repellent. Velcro® closure.

PART# 3H0098  
**\$36<sup>31</sup>**

## MAGNA-TRAK® MAGNETIC LOCATORS

High impact plastic case is water-resistant, lightweight and epoxy sealed. On/Off, Volume, and Sensitivity controls. "High-Tech" magnetic toroidal sensors and electronic balancing circuitry.

- Length: 42-3/4"; weight: 3 lbs./1.3kg
- Waterproof up to housing: water-resistant housing
- Easy access battery compartment
- Strong, lightweight aluminum tube with durable hard rubber tie

### MODEL MT100

Features: Sensitivity control, volume control, LCD digital display, and low battery indicator.

PART# 2D0231  
**\$569<sup>99</sup>**

CST/berger

### MODEL MT202

Features: Erase feature, power line indicator; sensitivity control, volume control, LCD digital display, low battery indicator, and analog bar graph.

PART# 2D0235  
**\$618<sup>99</sup>**



## SPECTRA PRECISION® LASER LEVEL LL500

The Spectra Precision® LL500 Laser Level is a one-person leveling system designed for longer range measurements across your entire site.

### Features:

- 1,600 ft (500 m) working diameter which increases productivity by reducing the need for multiple set-ups on a large job site.
- Self-leveling with built-in 'out-of-level' shut off that maintains accuracy over the entire work area, and minimizes errors.
- High accuracy laser; 1/16 in. per 100 ft. (1.5 mm per 30 m) with temperature compensation provides highly stable, repeatable accuracy even under large temperature changes.
- Visible 'spotting' beam for determining receiver mounting placement making it faster to find the on-grade position.

### Applications:

- Checking/setting elevations, concrete forms, footings, and foundations for medium to large commercial jobs.
- Excavating, digging footings, and septic tanks.
- Sub-base leveling with skid steer loaders.
- Longer range machine control applications.

### MODEL LL500

Includes: LL500 Laser Level with HL700 Laserometer; Rod Clamp with Bubble Vial, Alkaline Batteries, Case

PART# 7S0005  
**\$1,377<sup>60</sup>**



**WE CARRY THE LATEST IN LASERS AND RECEIVERS FROM SPECTRA PRECISION!**

## MARKING WHISKERS™

6" Marking Whiskers™ are an alternative marking choice for survey and construction sites, underground utility locating and many other uses. Virtually indestructible, these APWA color-coded Marking Whiskers™ spring back up when run over by lawn mowers, graders and heavy equipment. They are easily and conveniently attached to wood stakes or to 60-penny nails (not included). Use them alone or in conjunction with other marking products. Sold as a case of 1,000. Priced per case.

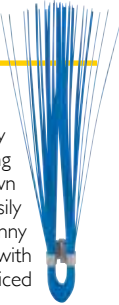

| Part # | Color           | Qty   | Price               |
|--------|-----------------|-------|---------------------|
| 4Q0004 | Standard Blue   | 1,000 | \$159 <sup>89</sup> |
| 4Q0005 | Standard Green  | 1,000 | \$159 <sup>89</sup> |
| 4Q0007 | Standard Red    | 1,000 | \$159 <sup>89</sup> |
| 4Q0009 | Standard Yellow | 1,000 | \$159 <sup>89</sup> |
| 4Q0010 | Orange PreGlo   | 1,000 | \$159 <sup>89</sup> |
| 4Q0011 | Pink PreGlo     | 1,000 | \$159 <sup>89</sup> |

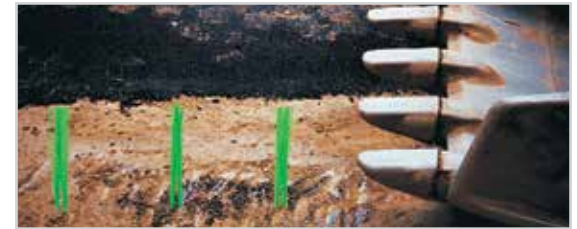

## SPECTRA PRECISION® PIPE LASERS

Rugged pipe lasers built for lasting performance, reliability, and repeatability. Use for installation of gravity flow sanitary pipelines, storm sewer pipelines, pipe jacking, and/or tunnel boring.

### Features:

- Rugged design is built for long lasting performance and reliability in the destructive underground environment. The DG813 is completely waterproof and its' shorter length fits into tight inverts in the manhole.
- DialGrades feature the largest automatic self-leveling range in the industry providing quick, easy setups.
- The DG813 features Line Alert where the beam flashes to notify you that the setup line has been disturbed, eliminating the necessity of rework.
- A full range of setup accessories and power options are available and are easy and straightforward to use.
- Maximum legal strength red laser beam and pipe targets with optical elements to enhance beam brightness make the beam easily visible in a variety of conditions.
- Remote controls for line and power included, DG813 remote control is full function with grade control and Line Set/Check function.



### MODEL DG813

Includes: DG813 Laser; 1248 trivet plate 8 inch (200mm), RC803 IR/Radio Remote Control, SF803 Spot Finder w/pole adapter & target plate, 956 target, ST802 Transporter; NiMH battery pack and charger

PART# 7S0014  
**\$4,788<sup>00</sup>**



## PERMANENT MOUNT TALLY COUNTER

Mounts on desk, dash, etc.

PART# 5T0259  
**\$23<sup>26</sup>**

